

LED Interior Lighting

2011

#H04206221 Hella, Inc. 6.10 Printed in USA



Hella LED Lighting

Where environmental choice meets economic sense. In a world where the development of renewable energy sources and the conservation of energy is given highest priority by scientists and decision makers, highly efficient LED lighting has a substantial role to play towards the lowering of our carbon footprint without sacrificing functionality or compromising safety.

Hella 'fit and forget' LED lighting is now firmly established as the solution of choice that fully meets both environmental and economic considerations of the astute operator in an ever growing catalog of applications.



Contents

Background Information

- 2 Technology

Dome Lamps

- 6 EuroLED Touch Series
- 7 EuroLED Series
- 8 DuraLED® Series
- 11 DuraLED® Junior Series
- 12 CargoLED Series
- 13 7373 Series

Spot Lamps

- 14 Rakino Series
- 15 Tiri Series
- 16 3980 SpotLED Series w/CELIS – Fixed
- 17 3790 SpotLED Series w/CELIS – Swivel
- 18 3680 SpotLED Series w/CELIS – Fixed
- 19 3700 SpotLED Series w/CELIS – Swivel

Reading Lamps

- 20 Mini OvalLED Series
- 21 Flexible SpotLED Series

Courtesy Lamps

- 22 8560 Easy Fit LED Series
- 23 9630 Surface Mount LED Series
- 24 Slim Line – Round Series
- 27 Slim Line – Square Series
- 30 9510 Oblong LED Series

Step Lamps

- 31 3660 Mini ThinLED Series
- 32 9680 LED Series
- 33 8078 LED CELIS Series

Strip Lamps

- 34 3606 LED Series
- 35 9073 LED Series
- 36 Waiheke Series

Applications & Index

- 38 Interior Lighting Application
- 38 Index by Part Number



Hella LED based lighting products are sophisticated opto-electronic devices designed for durable, highly energy efficient, maintenance free operation. Listed below are some key considerations when selecting LED based lamps for exterior and interior applications.

Ultra Low Power Consumption

Combining efficient LED light sources with advanced optic technology, Hella LED products deliver more light output per watt than traditional bulb lamps and thus provide considerable energy savings. As an example, Hella's DuraLED® 36 LED lamps use less than 15% of the power required to run a 60W fluorescent lamp, yet provide a considerably wider, whiter and more intense light pattern.

No bulbs, No maintenance. Ultra long service life

Hella LED technology has no filaments to break, thus making the LED lamps extremely shock and vibration resistant for reliable illumination and safety. Our engineering team has developed a unique range of highly demanding tests to increase product reliability to new standards.

Lens and Optic Technology

LED based interior lighting has become a viable solution for durable and highly energy efficient lighting. To take advantage of the ever increasing efficiency of the most advanced LEDs available, highly efficient optic design is essential.

The goal for general LED interior lighting is the even illumination of a specified area or to highlight and illuminate features of a vehicle. All Hella LED lamps use integrated highly efficient optics, lens designs or Free-Form reflector technology to accurately capture and distribute the light available from the LED. Examples include: - Oblong LED step lamps with 30 degree down angle light beam to illuminate the tread of steps and stairs without dazzle from the lamps themselves.

- Round and Square LED courtesy lamps providing attractive uniform light patterns via an efficient optic and lens with embedded glass spheres for minimum light losses.

- EuroLED lamps employ an accurately machined optic and lens combination to provide an even spread of bright white light with minimum light losses.

- LED spot lamps use an innovative reflector to create a powerful interior spot light pattern without causing glare.

Light Output

For an effective comparison of the different products from LED manufacturers, many factors must be considered. The best lamp for a given application is no longer the one that solely meets a style requirement. Today, power consumption, efficiency, output and beam angle must be considered together with light color, shape, and the

aesthetics and finish of the housing itself. The following performance data is worth considering -

Luminous flux is measured in Lumens (lm), luminous flux describes the total quantity of light produced from a lamp. The higher the lumen count, the more intense the light output. Luminous intensity is measured in Candela (cd), luminous intensity is the luminous flux at a particular angle from the light source.

Peak candela occurs at 0 degrees, i.e. directly below a lamp. Illuminance measured in Lux (lx), Illuminance is equal to luminous flux divided by the illuminated area. One lux is equal to one lumen per square meter. Luminous Flux (Lumens) / Area = Illuminance (Lux) or Illuminance (Lux) x Area = Luminous Flux (Lumens). If both the area to be illuminated and the desired level of illumination are known, the total number of lumens required can be calculated. Divide the total lumens by the output of the LED lamp under consideration to determine the number of fixtures required to deliver the desired light output.

Eg, A salon of 10 square meters and the desired illumination level is 120 Lux, a total of 1200 lumens are required. If the LED lamp under consideration has a luminous flux of 80 lumens, 15 lamps will be required (1200 / 80 = 15).

For further comparisons, it is also important to consider the beam angle of an LED lamp, and the Lux levels available at varying distances from the device. Narrow light beams may provide effective intensity directly under the fitting, but may not evenly illuminate an interior as the light may be too narrow with many shadows between effectively lit areas.

No formula exists for lighting designers to directly correlate the luminous flux of the LED component used or the power consumption of the LED device to the performance of the entire LED fixture.

While the lumen output of the LED does describe how much luminous flux is generated, it does not indicate how effectively that light is distributed. The Hella light performance diagrams show output and spread in two formats. The Candela curves show peak candela across a range of angles and illustrate the light pattern and peak intensity according to the scales used. (A uniform scale for all diagrams is used to aid product comparisons).

The Lux charts show the spread of light, calculated first from the candela curve by determining the angle where half of the peak candela output occurs.

In Fig 1, peak candela is 375cd (measured at 0 degrees). Half of the output (187.5cd) occurs at +/- 7.5 degrees, thus the lamp has a spread of 15 degrees. While there will be light beyond these angles, the majority of the light will occur inside the range shown. The Lux data shows how much light is cast upon a surface at given distance. The diagrams indicate peak Lux (at 0 degrees), Lux at the specified angle and the approximate length of surface area that will be illuminated inside the range shown.

Fig 1. Hella marine Rakino series (page 14) LED Downlight (Spot) Candela and Lux performance

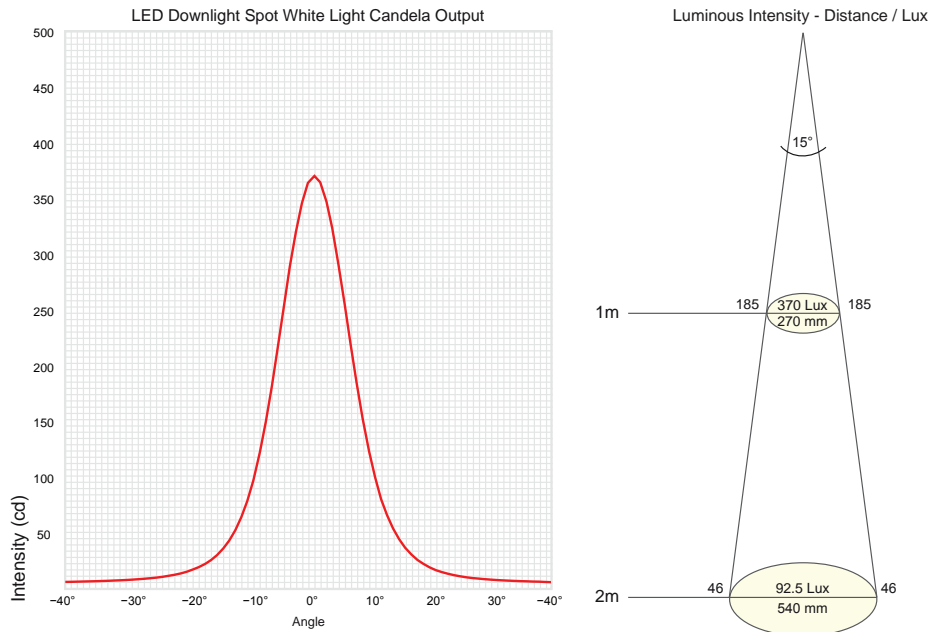

Optics and Eye Safety.

With the significant advances of LED brightness, eye safety considerations are increasingly important. It is essential for high power LEDs to be coupled with optic designs that protect the eye's retina from possible damage.

It is desirable for the entire lens area of a lamp to be evenly illuminated via an efficient optic rather than using a bundle of LEDs without any optic.

Heat and thermal management.

Competent and well engineered thermal management of an LED device is essential for the long-term durability of Hella LED lamps. Well designed LED interior lamps save power and reduce the heat in a cabin compared to incandescent lighting. A common misunderstanding is that LEDs do not generate heat. In contrast to incandescent lamps however LEDs like to 'run cold'. High output LEDs do generate heat, which needs to be coupled to surfaces designed to efficiently transport the heat away from the LED itself. LEDs that overheat, meaning the junction temperature of the LED rises above a set threshold, will permanently degrade and significantly reduce their luminous efficiency and lifetime.

A noticeably 'hot to touch' exterior surface of a high output LED interior lamp provides some indication that the light output of the device will deteriorate within a few hundred hours. Well engineered LED devices will operate 'cool' or 'slightly warm' to the touch after many hours of operation. The technical expertise of Hella in thermal management, coupled with superior optics and electronic design, ensures the long term durability of all our LED lighting products with minimal degradation over many years of service.

Technology

Color Temperature.

Until recently, the lack of high quality white LED devices with sufficient intensity has been the major factor preventing the acceptance of LEDs for general lighting purposes. LEDs had a reputation for appearing 'cold' and 'blue' due to their* phosphorous coating heritage. However today's high efficiency devices can rival traditional incandescent light sources for color and ambience. When selecting LED interior lighting, color temperature is an important consideration.

Color temperature is measured in Kelvin and describes the effect of heating an object until it glows incandescently. The emitted radiation, and apparent color changes in proportion to the temperature; envisioned when considering hot metal in a forge that glows red, then orange, and then white as the temperature increases. Hella describes higher color temperatures (>5200K or more) as 'cool' white, and lower color temperatures (<3500 K range) as 'warm white'. Cool is recommended for visual tasks, work areas such as engine rooms, and exterior lighting.

Warm white light is suggested for interior spaces as it adds life and vibrancy to people and objects, is considered more flattering to skin tones or fabrics, and makes food look fresh and attractive. These color choices should only be an approximate consideration however. Cool white will accentuate blue and green hues in certain fabrics or surfaces, and where there are stainless steel or gel coat surfaces. Lighting designers may specify cool white for galley areas and warm white where there is an abundance of varnished timber work instead of shiny white gel coat.

Color temperature examples

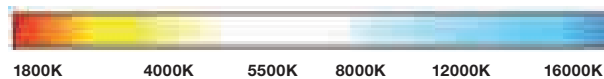

- 1850 K Candle
- 2800 K Halogen G4 Bulb (Incandescent lamp)
- 3000 K Hella Warm White LED courtesy lamp
- 5200 K Hella White EuroLED lamp
- 5400 K Hella White LED courtesy lamp
- 6500 K Daylight



White Light



Warm white Light

Requirements and Testing

IP Degrees of Protection Definition

IP stands for International Protection, the IP degrees of protection are determined by DIN 40050 part 9.

This standard exists to specify the exact protection of electrical equipment against penetration by solid foreign matter, including dust and water. The exact degree of protection is achieved by various tests.

eg; The IP rating of the CargoLED is listed as IP 6K 9K.
This means dust tight and protected from high pressure cleaning.

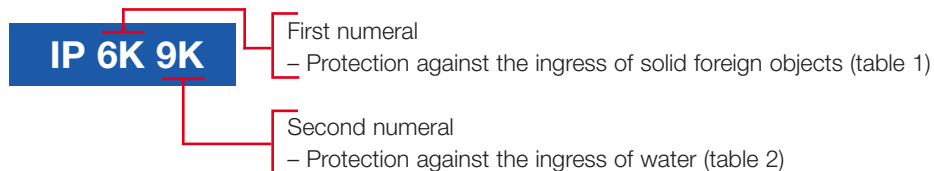

Table 1:
Protection against the ingress of solid foreign objects (including dust)

X	not tested
0.....	not protected
1.....	solid foreign objects greater than or equal to 50 mm
2.....	solid foreign objects greater than or equal 12.5 mm
3.....	solid foreign objects greater than or equal 2.5 mm
4.....	solid foreign objects greater than or equal 1.0 mm
5 and 5K....	dust protected
6 and 6K....	dust tight

Table 2:
Protection against the ingress of water

X	not tested
0.....	not protected
1.....	vertical dripping
2.....	dripping (inclined 15°)
3.....	spraying
4.....	splashing
4K	same with increased pressure
5.....	jetting
6.....	powerful jetting
6K	same at increased pressure
7.....	temporary immersion
8.....	continuous immersion
9K	high pressure/steam jet cleaning

LED Multivolt

Multivolt™ technology for durability and safety.

Advanced Multivolt™ circuitry provides a uniform level of intensity for reliable and safe illumination across a range of DC inputs such as 8-28 volts or 9-33 volts. Multivolt™ LED lamps can be connected to 12 or 24 volt systems without modification, providing full light performance and automatic compensation for low battery voltages and voltage drop over long cables and connections. Hella Multivolt™ LED lamps are also reverse polarity and spike protected for enhanced durability even under severe voltage fluctuations.



Electromagnetic Compatibility (EMC)

Hella LED products are electronic devices. Their electrical circuits contain components that suppress possible interference, both emission as well as susceptibility to immissions, to the limits prescribed in international standards.

***All measurements for the diagrams in millimeters (1mm = 0.039 in.).**

Explanation of Light Pyramid



lx = lux (measure of the apparent intensity of light hitting or passing through a surface)

E = illuminance

= angle

Ø = diameter

= light source



EuroLED Touch Series

Dome Lamps

Touch-Sensitive Technology



EuroLED Touch lamps provide red/white, blue/white or white only light using the latest water-resistant touch-sensitive technology. Lighting control is beautifully simple with EuroLED Touch lamps. Touch the color pad for red or blue light, the white pad for white light. On the dual color versions, hold your finger on the pad for more than two seconds and the lamp will cycle through four dimming levels. Release your finger on the light level required. Light levels are 'remembered' by the lamps circuitry, even when the batteries are turned off. The lamp will always turn on at the color intensity previously set, regardless of power interruption. EuroLED Touch current draw is 4W on white (0.33A at 12V) and less than 1.5W on red or blue (less than 0.125A at 12V) to provide significant power savings. Glare diffusion without light loss is important with any LED lamp to maintain efficiency and safety, particularly with powerful lamps such as the EuroLED series.

- Heavy-duty bezel clips over lamp body.
- Water-resistant housing and cable entry.
- Mounting bosses eliminate torque load on housing.
- Multivolt™ 9-33V DC.
- Power Consumption: White - 4W, Red and Blue - less than 1.5W.
- Reverse polarity, spike protected.
- UV resistant, enhanced impact acrylic.
- White - Single LED, Red and Blue - Multiple LEDs.
- Pre-wired with 8.2' (2.5m) cable.
- Surface Mount.
- IP 6K6/6K7.
- (Screws not included).

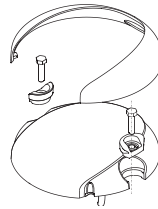
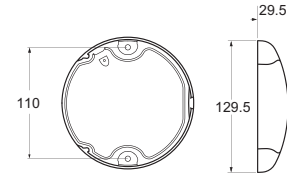

EuroLED® Touch Candela and Lux performance. White light.

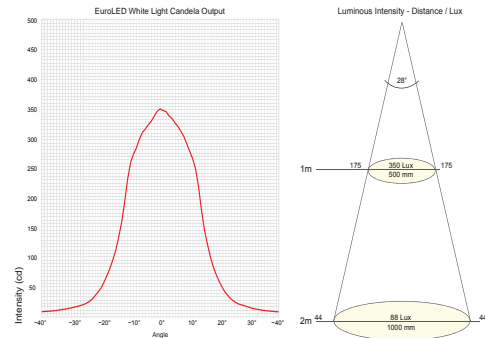

EuroLED Spacer Ring Accessories

Eliminates the need for cable hole behind lamp.

- 959952002 Black Spacer Ring
- 959952012 White Spacer Ring



Dual color EuroLED Touch lamps with dimming and remote momentary switch control. Touch the color pad for ON/OFF, hold finger on the pad to cycle through dimming levels.



White / Red EuroLED Touch Lamps

Bezel Color	Part Number	Bulk Part Number
Black Bezel	959950111	959950117
White Bezel	959950121	959950127

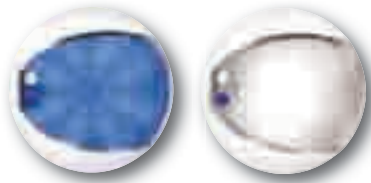

White / Blue EuroLED Touch Lamps

Bezel Color	Part Number	Bulk Part Number
Black Bezel	959951111	959951117
White Bezel	959951121	959951127



Single White EuroLED Touch Lamps

Bezel Color	Part Number	Bulk Part Number
Black Bezel	959950511	959950517
White Bezel	959950521	959950527

*Individual part numbers are packaged in Hella Marine blister packs.

Precision Optics, Impressive Light Output

EuroLED interior lamps combine the power saving benefits of single LED technology with precision optics providing impressive light output and energy efficiency. With a current draw of less than 4W (less than 0.33A at 12V), EuroLED lamps save power. They consume 40% of the energy required to operate a 10W incandescent interior lamp. Multivolt™ technology provides consistent illumination and circuit protection from 9-33V DC, even under severe voltage fluctuations.

- Heavy duty bezel clips over lamp body.
- Completely sealed housing and cable entry, impact resistant and shock resistant.
- Mounting bosses eliminate torque load on housing.
- UV resistant, enhanced impact acrylic.
- Pre-wired with 8.2' (2.5m) cable.
- Multivolt™ 9-33V DC.
- Power Consumption: Less than 4W.
- Reverse polarity, spike protected.
- Surface Mount.
- IP 6K6/6K7.
- (Screws not included).



LED Multivolt White EuroLED Lamps		
Bezel Color	Part Number	Bulk Part Number
Black Bezel	959820511	959820517
White Bezel	959820521	959820527

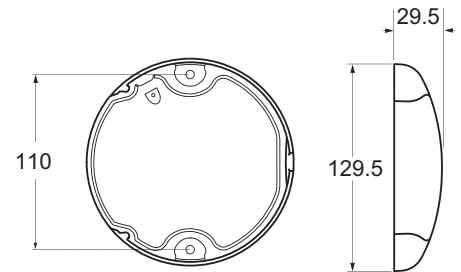

LED Multivolt Warm White EuroLED Lamps		
Bezel Color	Part Number	Bulk Part Number
White Bezel	959820321	959820327

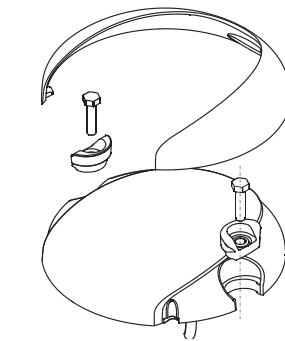

EuroLED® Candela and Lux performance. White light.

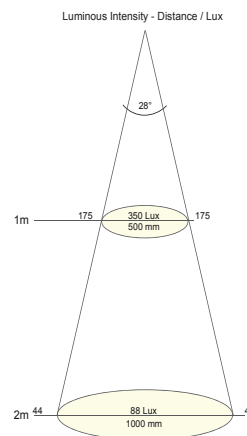
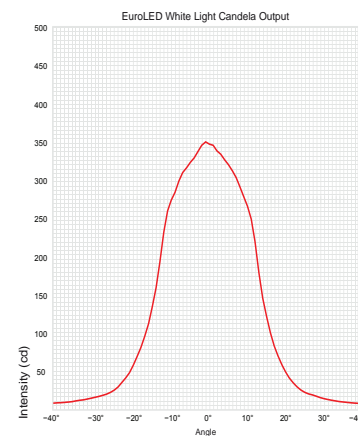

EuroLED Spacer Ring Accessories

Eliminates the need for cable hole behind lamp.

- 959952002 Black Spacer Ring
- 959952012 White Spacer Ring



*Individual part numbers are packaged in Hella Marine blister packs.



DuraLED® Series

Dome Lamps

DuraLED® 20 Heavy-Duty Interior Lighting

Hella DuraLED® interior lamps offer ultra durable lighting for heavy duty interior and exterior applications including storage lockers, tender lighting and wet areas. Completely sealed and highly resistant to vibration, saltwater and impact, DuraLED® lamps provide impressive light output and energy efficiency. Multivolt™ technology provides consistent illumination and circuit protection from 9-33V DC, even under severe voltage fluctuations. DuraLED® lamp reliability is second to none. Each lamp is completely waterproof, impact resistant and shock resistant, ensuring an ultra long service life.

- UV resistant, enhanced impact acrylic.
- Pre-wired with 8.2' (2.5m) cable.
- Reverse polarity and spike protected.
- Multivolt™ 9-33V DC.
- Power Consumption: < 4W (<0.33A at 12V).
- Surface Mount.
- IP 6K6/6K7.
- (Screws not included).



Completely sealed unit with robust mounting system

LED
Multivolt

CLEAR
LENS

White DuraLED® 20 Lamp - Diffused Light

Bezel Finish
White bezel

Part Number
980608001

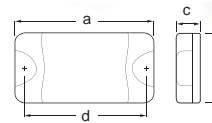

Dimensions

- a = 177mm / 6.97i
- b = 100mm / 3.94i
- c = 30mm / 1.18i
- d = 148mm / 5.83i

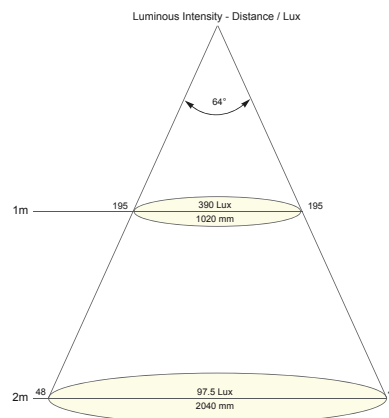
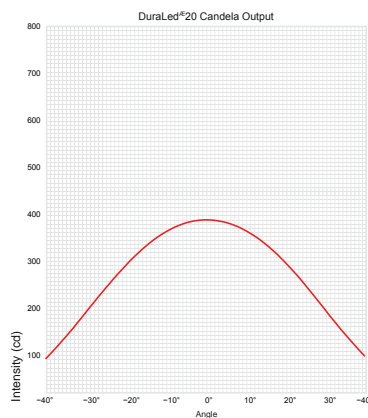

*Individual part numbers are packaged in Hella Marine blister packs.

DuraLED® 36 Heavy-Duty Interior Lighting

These lamps are designed and manufactured in New Zealand for harsh environmental conditions and to withstand long-term exposure to very high UV levels without fading. The DuraLED® range delivers a crisp white light close to daylight resulting in fatigue reduction and enhanced work safety. In an environment where energy conservation is a high priority these lamps challenge existing lighting solutions. The DuraLED® 36 LED Lamp consumes less than 9 watts and is available in Spread, Pencil and Narrow Beams, or with white housing and diffused light. The range of applications for these products is limitless – refrigerated vehicles, work shops, mining, warehouses, forestry, truck and bus interiors, RVs, walkways, road works, building exteriors and agriculture – just to name a few. Being Multivolt™, these lamps are offering a compatible tie up with solar energy installations and are a 'Fit and Forget' solution for both interior and exterior applications.

Lens Material - Grilamid

Grilamid is a high-performance polyamide developed and manufactured in Switzerland, and is a revolutionary new transparent plastic with exceptional properties. Grilamid's long-term resistance to UV degradation matches our impact enhanced Acrylic used in most Hella LED lamps but is characterised by very high impact and fatigue strength with resistance to chemicals and stress cracking. Hella has benchmarked Grilamid as the ideal lens material for ultra durable lighting applications exposed to stone impact and rough environments. Grilamid is not a commodity material and was developed for demanding applications such as medical apparatus, sight glasses and high value shatterproof sunglasses. The application of Grilamid for optical lenses for ultra durable LED lighting solutions is currently unique in the world.

- UV resistant, enhanced impact acrylic.
- Pre-wired with 8.2' (2.5m) cable.
- Reverse polarity and spike protected.
- Multivolt™ 9-33V DC.
- Power Consumption: <9W (<0.51A at 12V).
- Surface Mount.
- IP 6K6/6K7.
- (Screws not included).



Completely sealed unit with robust mounting system

LED
Multivolt

CLEAR LENS

White DuraLED® 36 Lamp

Bezel Finish

White bezel Diffused Light
Charcoal bezel

Spread

959037521
959037211

Pencil

959037311

Narrow

959037411

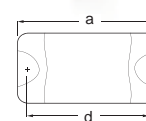

Dimensions

a = 177mm / 6.97i
b = 100mm / 3.94i
c = 30mm / 1.18i
d = 148mm / 5.83i

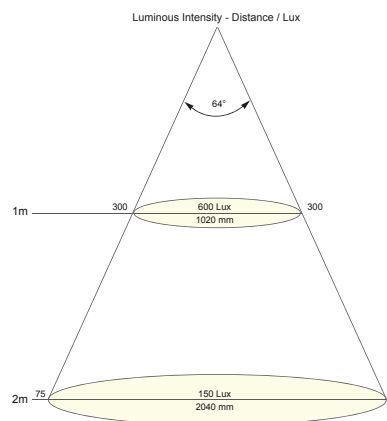
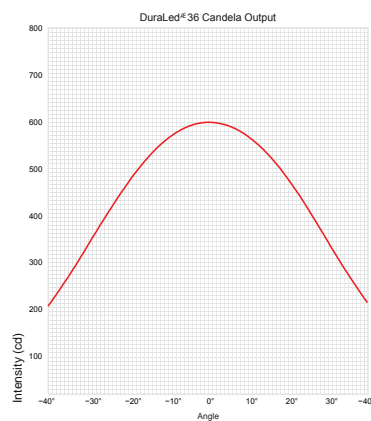

*Candela / Lux diagram only applies to part number 959037521.



DuraLED® Series

Dome Lamps

DuraLED® 50 Heavy-Duty Interior Lighting

These lamps are designed and manufactured in New Zealand for harsh environmental conditions and to withstand long-term exposure to very high UV levels without fading. The DuraLED® range delivers a crisp white light close to daylight resulting in fatigue reduction and enhanced work safety. In an environment where energy conservation is a high priority these lamps challenge existing lighting solutions. DuraLED® 50 LED Lamp consumes less than 12 watts and is available in Spread beam. The range of applications for these products is limitless – refrigerated vehicles, work shops, mining, warehouses, forestry, truck and bus interiors, RVs, walkways, road works, building exteriors and agriculture– just to name a few. Being Multivolt™ these, lamps are offering a compatible tie up with solar energy installations and are a ‘Fit and Forget’ solution for both interior and exterior applications.

Lens Material - Grilamid

Grilamid is a high-performance polyamide developed and manufactured in Switzerland, and is a revolutionary new transparent plastic with exceptional properties. Grilamid’s long-term resistance to UV degradation matches our impact enhanced Acrylic used in most Hella LED lamps but is characterised by very high impact and fatigue strength with resistance to chemicals and stress cracking. Hella has benchmarked Grilamid as the ideal lens material for ultra durable lighting applications exposed to stone impact and rough environments. Grilamid is not a commodity material and was developed for demanding applications such as medical apparatus, sight glasses and high value shatterproof sunglasses. The application of Grilamid for optical lenses for ultra durable LED lighting solutions is currently unique in the world.

- UV resistant, enhanced impact acrylic.
- Pre-wired with 8.2' (2.5m) cable.
- Reverse polarity and spike protected.
- Multivolt™ 9-33V DC.
- Power Consumption: <12W (<0.80A at 12V).
- Surface Mount.
- IP 6K6/6K7.
- (Screws not included).

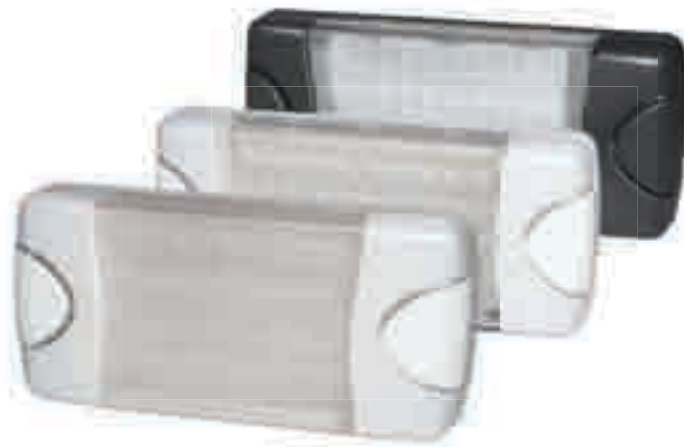

Completely sealed unit with robust mounting system



White DuraLED® 50 Lamp

Bezel Finish
 White bezel Diffused Light
 White bezel
 Charcoal bezel

Part Number
 980604011
 980604001
 980604031

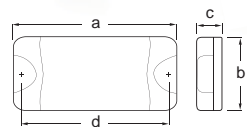

Dimensions
 a = 220mm / 8.661
 b = 96mm / 3.781
 c = 31mm / 1.221
 d = 193mm / 7.601

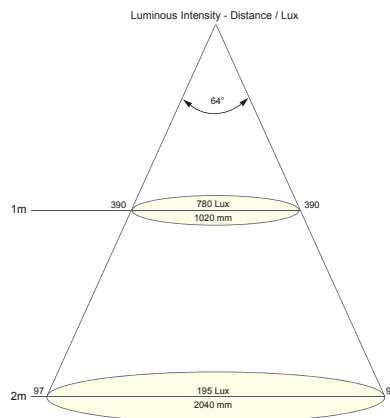
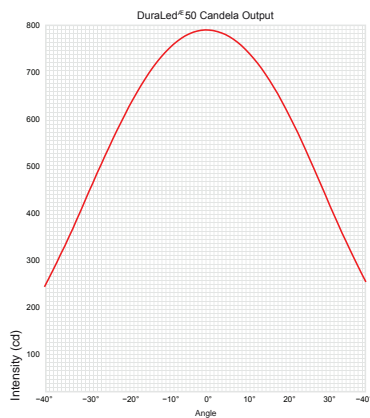

*Candela / Lux diagram only applies to part number 980604011.

Heavy-Duty Interior or Exterior Lighting

Suitable for a variety of applications, interior or exterior, wet or dry, the DuraLED® Junior draws less than 2.5W (<0.20A at 12V) offering substantial power saving compared to incandescent lighting. A combination of the unique design and precision of Hella optics provides an ultra wide spread of intense white light without glare or eye strain. Each lamp is a completely sealed unit, highly impact resistant to vibration and salt water. A robust surface mounting system provides secure installations, with no external fastenings.

- UV resistant, enhanced impact acrylic.
- Color temperature is 5000K (white).
- Pre-wired with 20" (500mm) cable.
- Multivolt™ 8-28V DC
- Power consumption <2.5W (<0.20A at 12V).
- Surface mount.
- IP 67 - Completely sealed.



LED Multivolt	CLEAR LENS	White DuraLED® Lamp			
		Bezel Finish White bezel	Part Number 959700101	Bulk Part Number 959700107	12V Bulk Part Number 959700157

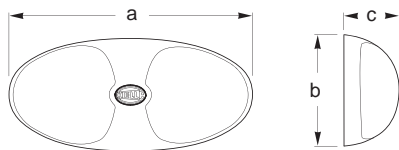

Dimensions
 a = 140 mm / 5.51f
 b = 65.0 mm / 2.56f
 c = 32.0 mm / 1.26f

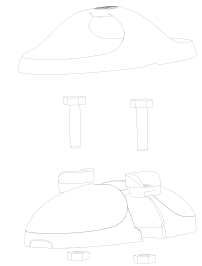

Completely sealed unit with robust bush mount.

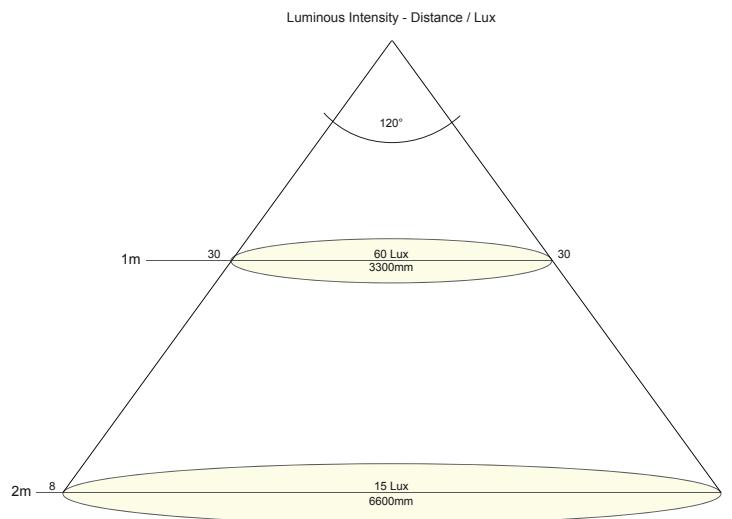
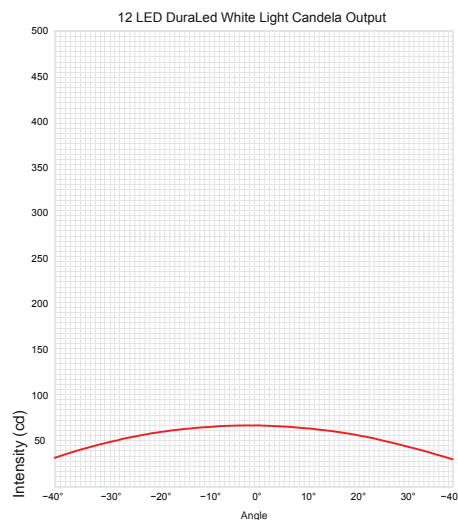



CargoLED Series

Dome Lamps

Non-Glaring, Heavy-Duty

CargoLED lamps offer ultra durable lighting for heavy duty interior and exterior applications including storage compartments, exposed surfaces and wet areas. Completely sealed and highly resistant to vibration, saltwater and impact. With a current draw of only 6W, CargoLED lamps provide impressive light output and energy efficiency. Multivolt™ technology provides consistent illumination and circuit protection from 9-31V DC, even under severe voltage fluctuations. The lamps are built with a unique 'non-glaring' LED installation. This provides ultra efficient LED light without risking eye damage if the lamps are viewed directly. CargoLED lamp reliability is second to none. Each lamp is completely waterproof, impact resistant and shock resistant, ensuring an ultra long service life. The new lamps operate across a wide range of temperatures from -40°F to 140°F (-40°C to +60°C). CargoLED lamps are the answer for low profile, ultra reliable and energy efficient lighting on powerboats, yachts, RVs or buses.

- UV resistant, enhanced impact acrylic lens.
- Anodized aluminum lamp base.
- Pre-wired with 12" (300mm) cable.
- Multivolt™ 9-31V DC.
- Power Consumption: 6W.
- Flush Mount.
- IP 6K9K.
- (Connectors, screws and other mounting hardware not included.)

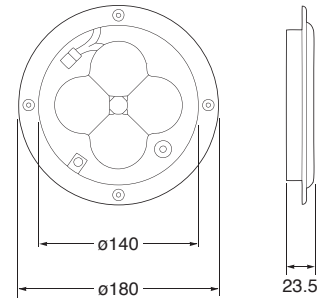

LED Multivolt **CLEAR LENS** **White CargoLED Lamp**

Part Number	Bulk Part Number
343227001	343227007

LED Multivolt **CLEAR LENS** **White CargoLED Lamp – Heavy Duty Version**

Part Number	Bulk Part Number
343227011	343227017

LED Multivolt **CLEAR LENS** **Warm White CargoLED Lamp**

Part Number	Bulk Part Number
343227041	343227047

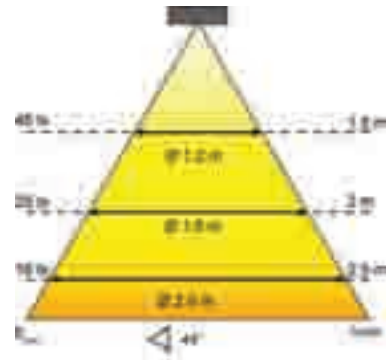

High-Power LEDs

7373 Series interior lamps provide innovative lighting technology with high-power LEDs. The lens and the frame are made of sturdy and impact resistant material. An on/off switch is integrated in the housing of the lamp. The LED modules are integrated into the PCB, which provides excellent thermal management and heat dissipation. Multivolt™ technology maintains a constant light output over a voltage range of 10 to 31V. The mounting pattern is identical to the one of the existing fluorescent lights 007373061 and -071, but the fluorescent tubes can not be replaced by the LED modules.

- Available with 12 or 24 LEDs.
- Pre-wired with 10" (254mm) cable.
- Power consumption 3.5W at 12V and 7W at 24V.
- IP 40
- Multivolt 10-31V DC.
- Color temperature is 4000K (neutral white).
- (Screws not included.)



LED Multivolt **CLEAR LENS** **White CargoLED Lamp 12 LEDs**
Part Number
007373151

LED Multivolt **CLEAR LENS** **White CargoLED Lamp 24 LEDs**
Part Number
007373161

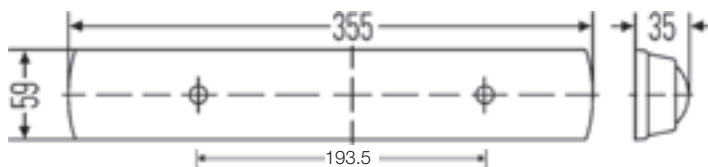

Rakino LED Downlight

Rakino LED downlights consume a fraction of the power of incandescent lamps and run very cool due to their low current draw. Power consumption is less than 0.8W per lamp (<0.07A at 12V / <0.03A at 24V) offering substantial power saving benefits compared to incandescent lighting. Advanced Hella lens and optic designs provide intense white or warm white light without glare or eye strain. Rakino downlights are available in 15° spot or 32° spread beam angles. The spot lamp is ideal for installations where the first surface requiring illumination is 1 meter or more from the lamp. Spread lamps are ideal for softer light where the first surface to be illuminated is less than 1 meter from the lamp. With a completely sealed lamp body of only 0.73" (18.5mm) deep, Rakino downlights can be installed almost anywhere interior, exterior, wet, or dry. Their ultra low heat signature will not cause damage to surrounding materials.

- Available in 12V or 24V DC versions, these LED lamps can be dimmed with the Hella 2 Group Light Dimmer 998572001 for ambient lighting effects.
- UV resistant enhanced impact acrylic (lens).
- UV resistant plastic/316 stainless steel (bezel).
- Color temperature is 5000K (white) or 3000K (warm white).
- Pre-wired with 5" (120mm) cable.
- 12V DC or 24V DC.
- IP 67 - Completely sealed.
- Recess mounted into 50mm diameter hole. Secured with 3 screws.



CLEAR LENS

White Rakino LED Downlight - Spot

Bezel Finish	12V Part Number	24V Part Number	12V Bulk	24V Bulk
Stainless steel bezel	959599551	959599651	959599557	959599657
White bezel	959599501	959599601	959599507	959599607

CLEAR LENS

White Rakino LED Downlight - Spread

Bezel Finish	12V Part Number	24V Part Number	12V Bulk	24V Bulk
Stainless steel bezel	959599051	959599151	959599057	959599157
White bezel	959599001	959599101	959599007	959599107

CLEAR LENS

Warm White Rakino LED Downlight - Spot

Bezel Finish	12V Part Number	24V Part Number	12V Bulk	24V Bulk
Stainless steel bezel	959596551	959596651	959596557	959596657
White bezel	959596501	959596601	959596507	959596607

CLEAR LENS

Warm White Rakino LED Downlight - Spread

Bezel Finish	12V Part Number	24V Part Number	12V Bulk	24V Bulk
Stainless steel bezel	959596051	959596151	959596057	959596157
White bezel	959596001	959596101	959596007	959596107

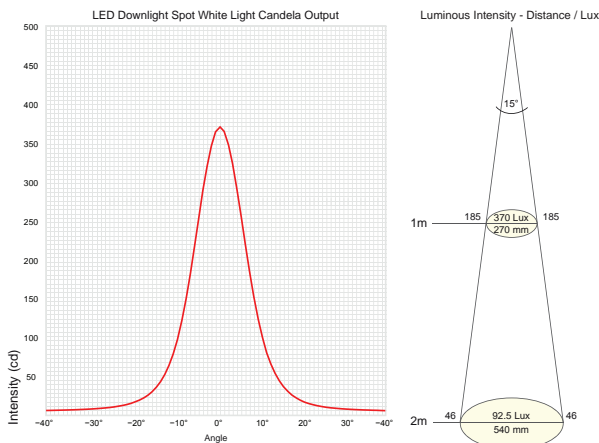

- Completely sealed housing
- Pre-wired with marine cable

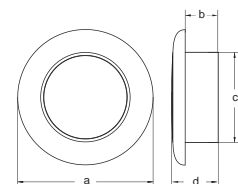

Dimensions

- a = 75.0 mm / 2.951" with plastic rim
72.0 mm / 2.831" with stainless steel rim
- b = 18.5 mm / 0.731"
- c = 50.0 mm / 1.971"
- d = 27.0 mm / 1.061"

*Candela / Lux diagram applies to Rakino and Tiri Spot Beam.

*Individual part numbers are packaged in Hella Marine blister packs.

Tiri LED Downlight

Tiri LED downlights consume a fraction of the power of incandescent lamps and run very cool due to their low current draw. Power consumption is less than 0.8W per lamp (<0.07A at 12V / <0.03A at 24V) offering substantial power saving benefits compared to incandescent lighting. Advanced Hella lens and optic designs provide intense white or warm white light without glare or eye strain. Tiri downlights are available in 15° spot or 32° spread beam angles. The spot lamp is ideal for installations where the first surface requiring illumination is 1 meter or more from the lamp. Spread lamps are ideal for softer light where the first surface to be illuminated is less than 1 meter from the lamp. With a completely sealed lamp body of only 0.73" (18.5mm) deep, Tiri downlights can be installed almost anywhere interior, exterior, wet, or dry. Their ultra low heat signature will not cause damage to surrounding materials.

- Available in 12V or 24V DC versions, these LED lamps can be dimmed with the Hella 2 Group Light Dimmer 998572001 for ambient lighting effects.
- UV resistant enhanced impact acrylic (lens).
- UV resistant plastic/316 stainless steel (bezel).
- Color temperature is 5000K (white) or 3000K (warm white).
- Pre-wired with 5" (120mm) cable.
- 12V DC or 24V DC.
- IP 67 - Completely sealed.
- Recess mounted into 50mm diameter hole. Secured with 3 screws.



CLEAR LENS	White Tiri LED Downlight - Spot				
	Bezel Finish	12V Part Number	24V Part Number	12V Bulk	24V Bulk
	Stainless steel bezel	980596531	980596631	980596537	980596637
	White bezel	980596501	980596601	980596507	980596607

CLEAR LENS	White Tiri LED Downlight - Spread				
	Bezel Finish	12V Part Number	24V Part Number	12V Bulk	24V Bulk
	Stainless steel bezel	980596031	980596131	980596037	980596137
	White bezel	980596001	980596101	980596007	980596107

CLEAR LENS	Warm White Tiri LED Downlight - Spot				
	Bezel Finish	12V Part Number	24V Part Number	12V Bulk	24V Bulk
	Stainless steel bezel	980597531	980597631	980597537	980597637
	White bezel	980597501	980597601	980597507	980597607

CLEAR LENS	Warm White Tiri LED Downlight - Spread				
	Bezel Finish	12V Part Number	24V Part Number	12V Bulk	24V Bulk
	Stainless steel bezel	980597031	980597131	980597037	980597137
	White bezel	980597001	980597101	980597007	980597107

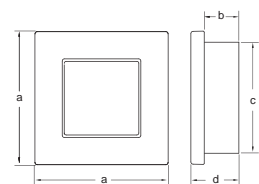
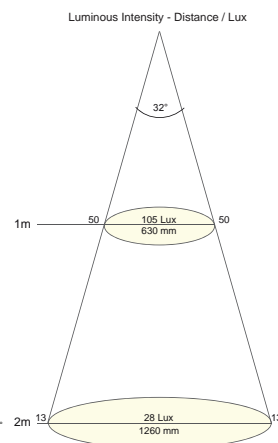
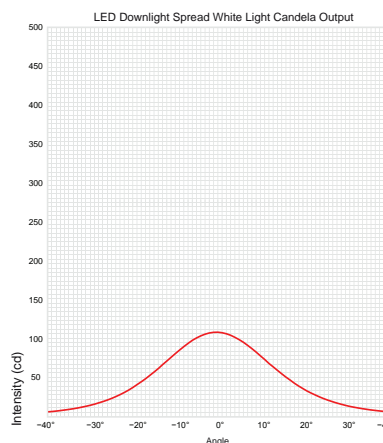

Dimensions
 a = 60.0 mm / 2.361
 b = 16.0 mm / 0.631
 c = 50.0 mm / 1.971
 d = 22.0mm / 0.871

*Candela / Lux diagram applies to Rakino and Tiri Spread Beam.

*Individual part numbers are packaged in Hella Marine blister packs.



3980 SpotLED Series w/CELIS – Fixed

Spot Lamps

Outstanding reliability

Hella high output LED spot lamps generate over 450 candela. Consumption is less than 2.5 W (less than 0.18A at 12V), providing more than 75% power saving compared to a 10W halogen bulb. Unique 'non-glare' reflector technology provides powerful light without discomfort to the eyes. The Lamps also feature an outer CELIS ring of red, blue or white LED light providing additional ambient illumination. The ambient function consumes less than 0.5W and is switched on independently. Completely sealed, shock and vibration resistant, Hella SpotLEDs provide outstanding reliability as there are no filaments to break. The surface is cool to the touch so will not cause damage to the surrounding materials. Bezels are available in polished or satin 316 stainless steel, gold stainless steel, and black, white or chrome high gloss plastic.

- Housing is made of UV and impact resistant plastic.
- Unique 'non glare' reflector design.
- Over 450 candela peak output.
- Completely sealed.
- Multivolt™ 9-33V DC.
- Power Consumption: Spot Light - < 2.5W, Ambient Ring - < 0.5W.
- Pre-wired with 8" (200mm) of triple core cable.
- Flush Mount/Screw Mount.
- IP 6K9K.
- (Screws and rubber seal included).
- (Screws not included in bulk packages).



Rear of lamp
- Sealed housing and cable entry.
- Pre-wired with 200mm of triple core cable.

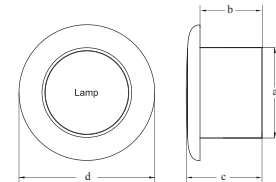

- a = 50mm
- b = 34mm
- c = 41mm
- d = 75mm plastic bezels
72mm stainless steel bezels



LED
Multivolt

CLEAR
LENS

White Spot Lamps with Blue CELIS Ring

Bezel Finish	Part Number	Bulk Part Number
White plastic bezel	343980102	343980107
Black plastic bezel	343980112	343980117
Chrome plastic bezel	343980132	343980137
Gold stainless steel bezel	343980142	343980147
Polished stainless steel bezel	343980152	343980157
Satin stainless steel bezel	343980162	343980167
Black, white, chrome bezels	343980511	



Blue Ambient Ring



White Spot

LED
Multivolt

CLEAR
LENS

White Spot Lamps with Red CELIS Ring

Bezel Finish	Part Number	Bulk Part Number
White plastic bezel	343980002	343980007
Black plastic bezel	343980012	343980017
Chrome plastic bezel	343980032	343980037
Gold stainless steel bezel	343980042	343980047
Polished stainless steel bezel	343980052	343980057
Satin stainless steel bezel	343980062	343980067
Black, white, chrome bezels	343980501	



Red Ambient Ring



White Spot

LED
Multivolt

CLEAR
LENS

White Spot Lamps with White CELIS Ring

Bezel Finish	Part Number	Bulk Part Number
White plastic bezel	343980202	343980207
Black plastic bezel	343980212	343980217
Chrome plastic bezel	343980232	343980237
Gold stainless steel bezel	343980242	343980247
Polished stainless steel bezel	343980252	343980257
Satin stainless steel bezel	343980262	343980267
Black, white, chrome bezels	343980521	



White Ambient Ring



White Spot

*Individual part numbers are packaged in Hella Marine blister packs.

Pleasant ambient lighting

Hella high output LED spot lamps generate over 450 candela. Consumption is less than 2.5 W (less than 0.18A at 12V), providing more than 75% power saving compared to a 10W halogen bulb. The lamps are available with or without a CELIS ring which provides a pleasant ambient atmosphere. The ambient function consumes less than 0.5W and is switched independently. Shock and vibration resistant, Hella SpotLED provides outstanding reliability as there are no filaments to break. The surface is cool to the touch so will not cause damage to the surrounding materials. The spot is adjustable with a 20 degree angle to all sides, making it easy to direct the light where it needs to be. Bezels are available in black or white plastic.

- The housing is made of UV and impact resistant plastic.
- Pre-wired with 8" (200mm) of triple core cable.
- Swivelling angle is 20 degrees.
- IP 3X
- Flush mount.
- Lamps can either be screw or spring mounted.
- (Connectors, screws and other mounting hardware not included).

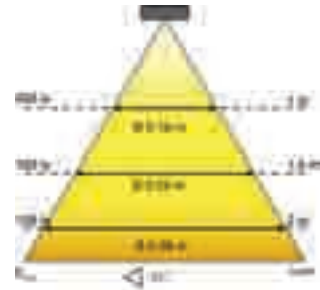

LED
Multivolt

CLEAR
LENS

White SpotLED Swivel Round with White CELIS Ring

Bezel Finish	Part Number	Bulk Part Number
White plastic bezel	343790201	343790207
Black plastic bezel	343790211	343790217



LED
Multivolt

CLEAR
LENS

White SpotLED Swivel Round with Red CELIS Ring

Bezel Finish	Part Number	Bulk Part Number
White plastic bezel	343790001	343790007
Black plastic bezel	343790011	343790017



LED
Multivolt

CLEAR
LENS

White SpotLED Swivel Round with Blue CELIS Ring

Bezel Finish	Part Number	Bulk Part Number
White plastic bezel	343790101	343790107
Black plastic bezel	343790111	343790117





3680 SpotLED Series w/CELIS - Fixed

Spot Lamps

CELIS Technology, Low Glare

SpotLED lamps are sophisticated LED interior lights designed for applications where there is a requirement for low glare, spill free lighting, with the option to change between white functional lighting and ambient blue, red or white design. These lights are available in screw and spring mount version, as well as with or without ambient ring. General illumination is provided by a single white LED located deep inside a reflector with a black sleeve to eliminate direct view of the light source and discomfort glare. A separately switched, low intensity LED illuminates a circular CELIS ring to provide low intensity ambient illumination for safety and night vision compatibility. The low power consumption, combined with minimal heat output in continuous use, and ergonomic smooth design of the SpotLED reduces personal injury risk in confined spaces.

- Pre-wired with 8" (200mm) cable.
- Multivolt™ 9-31V DC.
- Power Consumption: Spot Light - <2.5W, Ambient Ring - <0.5W.
- Flush Mount.
- Lamps can be screw or spring mounted.
- IP 6K9K.
- (Connectors, screws and other mounting hardware not included).

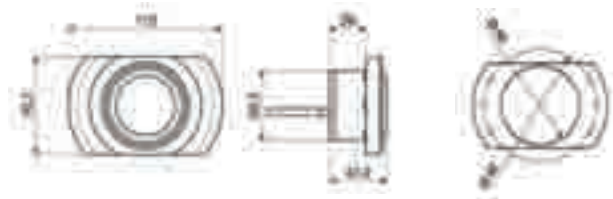
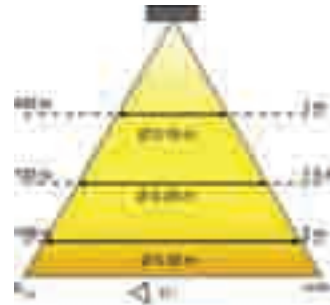

LED
Multivolt

CLEAR
LENS

White SpotLED Fixed Oval without CELIS Ring

Bezel Finish	Part Number	Bulk Part Number
White plastic bezel	343680201	343680207
Black plastic bezel	343680251	343680257



LED
Multivolt

CLEAR
LENS

White SpotLED Fixed Oval with White CELIS Ring

Bezel Finish	Part Number	Bulk Part Number
White plastic bezel	343680241	343680247
Black plastic bezel	343680291	343680297



LED
Multivolt

CLEAR
LENS

White SpotLED Fixed Oval with Red CELIS Ring

Bezel Finish	Part Number	Bulk Part Number
White plastic bezel	343680211	343680217
Black plastic bezel	343680261	343680267



LED
Multivolt

CLEAR
LENS

White SpotLED Fixed Oval with Blue CELIS Ring

Bezel Finish	Part Number	Bulk Part Number
White plastic bezel	343680221	343680227
Black plastic bezel	343680271	343680277



3700 SpotLED Series w/CELIS – Swivel



Spot Lamps

Functional, Adjustable Lighting

SpotLED lamps are ideal lights for changing needs. The spot light can be used for areas, where a powerful light is required, such as reading areas or under cabinets. The adjustable functionality makes it easy to shine the light anywhere in a 20 degree angle. The ambient ring provides pleasant illumination for safety and night vision.

- Pre-wired with 8" (200mm) cable.
- Multivolt™ 9-31V DC.
- Power Consumption: Spot Light - <2.5W, Ambient Ring - <0.5W.
- Flush Mount.
- Lamps can be screwed or spring mounted.
- IP 3X.
- (Connectors, screws and other mounting hardware not included).

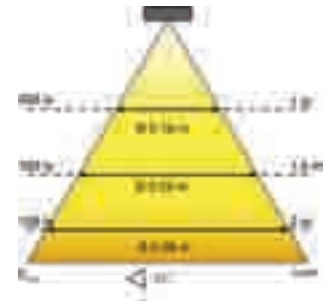

LED
Multivolt

CLEAR
LENS

White SpotLED Swivel Oval without CELIS Ring

Bezel Finish	Part Number	Bulk Part Number
White plastic bezel	343700201	343700207
Black plastic bezel	343700251	343700257



LED
Multivolt

CLEAR
LENS

White SpotLED Swivel Oval with White CELIS Ring

Bezel Finish	Part Number	Bulk Part Number
White plastic bezel	343700241	343700247
Black plastic bezel	343700291	343700297



LED
Multivolt

CLEAR
LENS

White SpotLED Swivel Oval with Red CELIS Ring

Bezel Finish	Part Number	Bulk Part Number
White plastic bezel	343700211	343700217
Black plastic bezel	343700261	343700267



LED
Multivolt

CLEAR
LENS

White SpotLED Swivel Oval with Blue CELIS Ring

Bezel Finish	Part Number	Bulk Part Number
White plastic bezel	343700221	343700227
Black plastic bezel	343700271	343700277





Mini OvalLED Series

Reading Lamps

Oval Illumination

Mini OvalLED lamps use a brilliant, clear lens and black housing. They provide oval illumination for the driver or instrument panel area and designed for overhead installation. The red or blue ambient light for map reading provided by one red or blue LED can be turned off. Choose between version with frame/switch or a version without frame/switch.

- Supplied with 6" (150mm) cable.
- Available in 12V or 24V.
- Power Consumption: Standard Version: 4 LED (white) and 1 LED (ambient red/blue) - 1.2W
- Flush Mount.
- IP 6K9K (Lamp) / IP 40 (Switch).
- (Screws and mounting hardware not included).

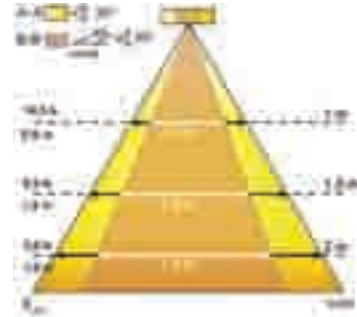
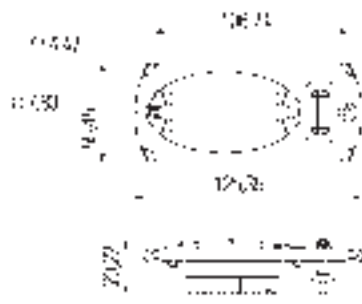
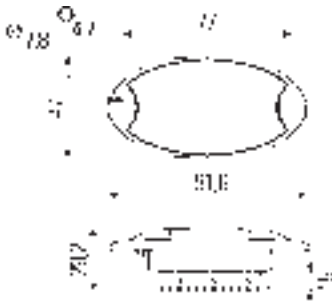

CLEAR LENS

White/Red Mini OvalLED Lamp

Voltage
12V
24V

Part Number
343570031
343570021

Bulk Part Number
343570037
343570027



CLEAR LENS

White/Red Mini OvalLED Lamp with Black Frame and Switch

Voltage
12V
24V

Part Number
343570071
343570061

Bulk Part Number
343570077
343570067



CLEAR LENS

White/Blue Mini OvalLED Lamp with Black Frame and Switch

Voltage
24V

Part Number
343570141

Bulk Part Number
343570147



Adjustable, Flexible Reading Lamps

Hella LED lamps offer durable energy efficient lighting for a variety of interior applications including chart table and navigation area lighting, berth lighting and adjustable reading lights. Excellent for map-reading. With a current draw of less than 3.5W (less than 0.16A at 12V), these flexible LED lamps have an impressive light output and are highly energy efficient. Available in single red or white LED or dual color red and white LED versions with intergrated dimming via rotary switch built in to the head. Hella Multivolt™ electronics provide consistent illumination and circuit protection across a range of inputs from 9-31V DC. Highly shock and vibration resistant, the lamps provide outstanding reliability. There are no filaments to break and the surface is cool and safe to the touch.

- Available in red, white or red/white LED light with shaft length of 6" (150mm) or 16" (400mm).
- Supplied with 6" (150mm) cable (mounted version only).
- Power Consumption: 3.5W.
- Multivolt™ 9-31V DC.
- Surface mount/cigarette lighter plug.
- IP 3X.
- (Screws and mounting hardware not included).

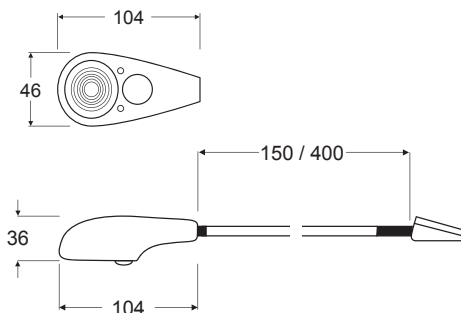
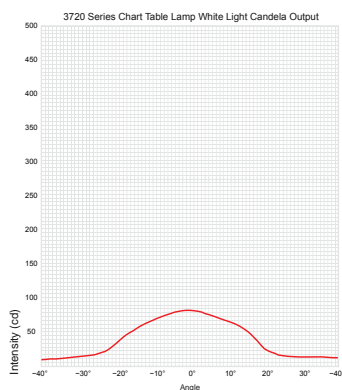
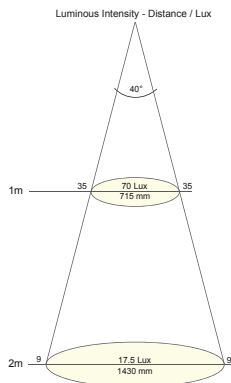

LED
Multivolt

CLEAR
LENS

White Flexible SpotLED Lamps

Shaft Length	Black Cover	Bulk Part Number
6" / 150 mm	343720022	343720027
16" / 400 mm	343720122	343720127
	White Cover	
6" / 150 mm	343720012	343720017
16" / 400 mm	343720112	343720117

6" / 150 mm **White Cover Cigarette Lighter**
343720071

6" / 150 mm **Black Cover Cigarette Lighter**
343720081

LED
Multivolt

CLEAR
LENS

Red Flexible SpotLED Lamps

Shaft Length	Black Cover	Bulk Part Number
6" / 150 mm	343720052	343720057
16" / 400 mm	343720152	343720157
	White Cover	
6" / 150 mm	343720042	343720047
16" / 400 mm	343720142	343720147

LED
Multivolt

CLEAR
LENS

Red / White Flexible SpotLED Lamps

Shaft Length	Black Cover
6" / 150 mm	343720522
16" / 400 mm	343720622



*Individual part numbers are packaged in Hella Marine blister packs.



8560 Easy Fit LED Series

Courtesy Lamps

Ultra compact design

Hella Easy Fit LED Courtesy lamps are ultra compact, power saving and attractive LED lamps for a wide variety of interior and exterior lighting applications. The light is radiated downward at an angle of 30 degrees making these lamps ideal for illuminating areas such as steps, stairs, toe kicks, storage areas, companion ways, deck fittings, signs and switches.

- UV and impact resistant acrylic.
- Pre-wired with 5"(120mm) cable.
- Completely sealed (housing).
- Multivolt™ 12-24V DC.
- Power Consumption: 0.5W.
- Flush Mount/Screw or Snap on.
- IP 6K9K.
- (Stainless steel screws included except for bulk part numbers).

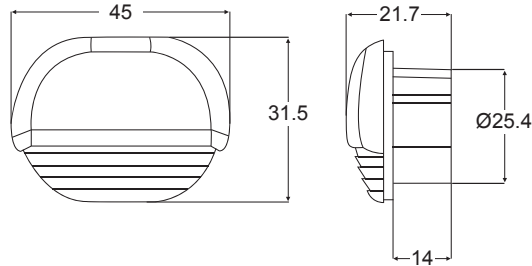

Mounting with screws.
Push on plastic cap versions.



Mounting with screws.
Stainless steel cap versions



Mounting without screws.
Push on plastic cap versions only.



- Completely sealed housing
- Pre-wired with marine cable

LED
Multivolt

CLEAR
LENS

White Easy Fit LED Step Lamps

Housing Finish	Part Number	Bulk Part Number
Chrome housing	998560001	998560007
White housing	998560011	998560017
Gold housing	998560081	998560087
Black housing	998560111	998560117
Satin chrome housing	998560121	998560127
Stainless steel housing	998560161	998560167



LED
Multivolt

CLEAR
LENS

Warm White Easy Fit LED Step Lamps

Housing Finish	Part Number	Bulk Part Number
Chrome housing	998560401	998560407
White housing	998560411	998560417
Gold housing	998560431	998560437
Black housing	998560421	998560427
Satin chrome housing	998560441	998560447
Stainless steel housing	998560451	998560457



LED
Multivolt

CLEAR
LENS

Blue Easy Fit LED Step Lamps

Housing Finish	Part Number	Bulk Part Number
Chrome housing	998560041	998560047
White housing	998560051	998560057
Gold housing	998560091	998560097
Black housing	998560151	998560157
Satin chrome housing	998560101	998560107
Stainless steel housing	998560171	998560177



LED
Multivolt

CLEAR
LENS

Amber Easy Fit LED Step Lamps

Housing Finish	Part Number	Bulk Part Number
Chrome housing	998560301	998560307
White housing	998560311	998560317
Gold housing	998560331	998560337
Black housing	998560321	998560327
Satin chrome housing	998560341	998560347
Stainless steel housing	998560351	998560357



LED
Multivolt

CLEAR
LENS

Red Easy Fit LED Step Lamps

Housing Finish	Part Number	Bulk Part Number
Chrome housing	998560201	998560207
White housing	998560211	998560217
Gold housing	998560231	998560237
Black housing	998560221	998560227
Satin chrome housing	998560241	998560247
Stainless steel housing	998560251	998560257



*Individual part numbers are packaged in Hella Marine blister packs.

Note: Lamp covers cannot be removed easily once clipped into place.

Stylish surface mount

Stylish, compact and completely sealed surface mounted LED courtesy lamps with Multivolt™ technology for low power consumption and an ultra long service life. Available with white, green, blue, amber and red LEDs.

- Completely sealed waterproof housing. UV and impact resistant plastic.
- Pre-wired with 20" (500mm) cable.
- Red, Amber - Multivolt™ 8-28V DC; Blue, White, Green - Multivolt™ 10-33V DC.
- Power Consumption: 0.5W.
- Reverse polarity and transient spike circuit protection.
- Surface Mount.
- IP6K7.

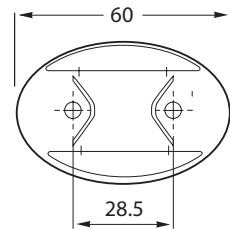
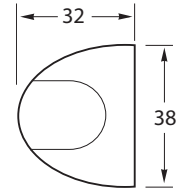

LED Surface Mount Lamps with Black Housings

LED Multivolt CLEAR LENS White LED Courtesy Lamp

Part Number 959630451 **Bulk Part Number** 959630457



LED Multivolt CLEAR LENS Green LED Courtesy Lamp

Part Number 959630551 **Bulk Part Number** 959630557



LED Multivolt CLEAR LENS Blue LED Courtesy Lamp

Part Number 959630251 **Bulk Part Number** 959630257



LED Multivolt CLEAR LENS Amber LED Courtesy Lamp

Part Number 959630151 **Bulk Part Number** 959630157



LED Multivolt CLEAR LENS Red LED Courtesy Lamp

Part Number 959630351 **Bulk Part Number** 959630357



Accessories

-  959565017
White housing
-  959565067
Blue housing
-  959565037
Red housing



Slim Line – Round Series

Courtesy Lamps



Variety of light and bezel colors

Hella LED lamps consume a fraction of the energy of traditional bulb lamps and run very cool due to their low current draw. This provides safer installation into light weight materials where the heat of traditional lamps may cause damage to the surrounding structure. Nine exciting light colors are available with an installation depth of only 13mm and an advanced lens for an even spread of soft light without glare or eye strain. Bezels are available in polished or satin 316 stainless steel, gold stainless steel, chrome, black or white plastic. High intensity versions are over three times brighter than regular white and warm white LED lamps. Each lamp is a completely sealed and waterproof unit, UV and corrosion resistant, perfectly suited for demanding environments. High intensity lamps include a surface mounting spacer with 3x stainless steel screws. Stainless steel and white bezel lamps include a white spacer, black bezel lamps a black spacer (supplied only with blister packages).

- Completely sealed housing.
- UV and impact resistant plastic.
- Pre-wired with 8" (120mm) cable.
- 50mm dia. installation hole when recess mounting.
- Power Consumption: 0.5W.
- Flush or Surface Mount.
- IP 67.
- (Stainless steel screws included except for bulk part numbers).

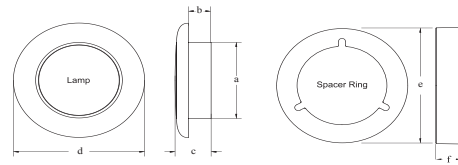

a = 50mm d = 75mm plastic bezels
 b = 13mm 72mm stainless steel bezels
 c = 21mm e = 75mm
 f = 15mm



Surface Mounting Accessories

959993102 Black Spacer Ring
 959993112 White Spacer Ring



High intensity LED Lamps

*High intensity lamps include a surface mounting ring with 3 x stainless steel screws. Stainless steel and white bezel single packaged lamps include a white spacer, black bezel lamps a black spacer. Bulk part numbers do not include spacers.

CLEAR LENS

White High intensity* LED Lamps

Bezel Finish	12V Part Number	24V Part Number	12V Bulk	24V Bulk
Satin stainless steel bezel	980500591	980501591	980500597	980501597
Polished stainless steel bezel	980500521	980501521	980500527	980501527
Gold stainless steel bezel	980500531	980501531	980500537	980501537
White plastic bezel	980500541	980501541	980500547	980501547
Black plastic bezel	980500551	980501551	980500557	980501557
Chrome plastic bezel	980500571	980501571	980500577	980501577



CLEAR LENS

Warm White High intensity* LED Lamps

Bezel Finish	12V Part Number	24V Part Number	12V Bulk	24V Bulk
Satin stainless steel bezel	980500791	980501791	980500797	980501797
Polished stainless steel bezel	980500721	980501721	980500727	980501727
Gold stainless steel bezel	980500731	980501731		980501737
White plastic bezel	980500741	980501741	980500747	980501747
Black plastic bezel	980500751	980501751	980500757	980501757
Chrome plastic bezel	980500771	980501771		980501777



*Individual part numbers are packaged in Hella Marine blister packs.

Slim Line – Round Series



Courtesy Lamps

Soft light output LED Courtesy Lamps

CLEAR LENS

White LED Courtesy Lamps

Bezel Finish	12V Part Number	24V Part Number	12V Bulk	24V Bulk
Satin stainless steel bezel	980500091	980501091	980500097	980501097
Polished stainless steel bezel	980500021	980501021	980500027	980501027
Polished stainless steel bezel packard connector			980500287	
Gold stainless steel bezel	980500031	980501031	980500037	980501037
White plastic bezel	980500041	980501041	980500047	980501047
White plastic bezel w/spacer	980500441			
White plastic bezel packard connector			980500137	
Black plastic bezel	980500051	980501051	980500057	980501057
Black plastic bezel w/spacer	980500451			
Chrome plastic bezel	980500071	980501071	980500077	980501077



CLEAR LENS

Warm White LED Courtesy Lamps

Bezel Finish	12V Part Number	24V Part Number	12V Bulk	24V Bulk
Satin stainless steel bezel	980500291	980501291	980500297	980501297
Polished stainless steel bezel	980500221	980501221	980500227	980501227
Gold stainless steel bezel	980500231	980501231	980500237	980501237
White plastic bezel	980500241	980501241	980500247	980501247
White plastic bezel w/spacer	980500641			
Black plastic bezel	980500251	980501251	980500257	980501257
Black plastic bezel w/spacer	980500651			
Chrome plastic bezel	980500271	980501271	980500277	980501277



CLEAR LENS

Amber LED Courtesy Lamps

Bezel Finish	12V Part Number	24V Part Number	12V Bulk	24V Bulk
Satin stainless steel bezel	980507091	980508091	980507097	980508097
Polished stainless steel bezel	980507021	980508021	980507027	980508027
Gold stainless steel bezel	980507031	980508031	980507037	980508037
White plastic bezel	980507041	980508041	980507047	980508047
White plastic bezel w/spacer	980507141			
Black plastic bezel	980507051	980508051	980507057	980508057
Black plastic bezel w/spacer	980507151			
Chrome plastic bezel	980507071	980508071	980507077	980508077



CLEAR LENS

Red LED Courtesy Lamps

Bezel Finish	12V Part Number	24V Part Number	12V Bulk	24V Bulk
Satin stainless steel bezel	980507301	980508291	980507307	980508297
Polished stainless steel bezel	980507221	980508221	980507227	980508227
Polished stainless steel bezel DT connector			980507287	
Polished stainless steel bezel packard connector			980507297	
Gold stainless steel bezel	980507231	980508231	980507237	980508237
White plastic bezel	980507241	980508241	980507247	980508247
White plastic bezel w/spacer	980507341			
White plastic bezel packard connector			980507317	
Black plastic bezel	980507251	980508251	980507257	980508257
Black plastic bezel w/spacer	980507351			
Chrome plastic bezel	980507271	980508271	980507277	980508277

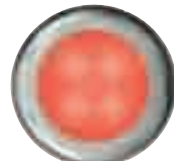

CLEAR LENS

Deep Red LED Courtesy Lamps

Bezel Finish	12V Part Number	24V Part Number
Satin stainless steel bezel	980507491	980508491
Polished stainless steel bezel	980507421	980508421
Gold stainless steel bezel	980507431	980508431
White plastic bezel	980507441	980508441
Black plastic bezel	980507451	980508451
Chrome plastic bezel	980507471	980508471



*Individual part numbers are packaged in Hella Marine blister packs.



Slim Line – Round Series

Courtesy Lamps



CLEAR LENS

Orange LED Courtesy Lamps

Bezel Finish	12V Part Number	24V Part Number
Satin stainless steel bezel	980507691	980508691
Polished stainless steel bezel	980507621	980508621
Gold stainless steel bezel	980507631	980508631
White plastic bezel	980507641	980508641
Black plastic bezel	980507651	980508651
Chrome plastic bezel	980507671	980508671

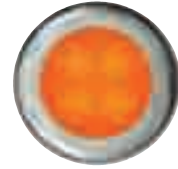

CLEAR LENS

Green LED Courtesy Lamps

Bezel Finish	12V Part Number	24V Part Number	12V Bulk	24V Bulk
Satin stainless steel bezel	980502091	980503091	980502097	980503097
Polished stainless steel bezel	980502021	980503021	980502027	980503027
Gold stainless steel bezel	980502031	980503031	980502037	980503037
White plastic bezel	980502041	980503041	980502047	980503047
Black plastic bezel	980502051	980503051	980502057	980503057
Chrome plastic bezel	980502071	980503071	980502077	980503077



CLEAR LENS

Blue LED Courtesy Lamps

Bezel Finish	12V Part Number	24V Part Number	12V Bulk	24V Bulk
Satin stainless steel bezel	980502291	980503291	980502297	980503297
Polished stainless steel bezel	980502221	980503221	980502227	980503227
Gold stainless steel bezel	980502231	980503231	980502237	980503237
White plastic bezel	980502241	980503241	980502247	980503247
White plastic bezel w/spacer	980502641			
Black plastic bezel	980502251	980503251	980502257	980503257
Black plastic bezel w/spacer	980502651			
Chrome plastic bezel	980502271	980503271	980502277	980503277



CLEAR LENS

Cyan LED Courtesy Lamps

Bezel Finish	12V Part Number	24V Part Number	12V Bulk	24V Bulk
Satin stainless steel bezel	980502491	980503491	980502497	980503497
Polished stainless steel bezel	980502421	980503421	980502427	980503427
Gold stainless steel bezel	980502431	980503431	980502437	980503437
White plastic bezel	980502441	980503441	980502447	980503447
Black plastic bezel	980502451	980503451	980502457	980503457
Chrome plastic bezel	980502471	980503471		

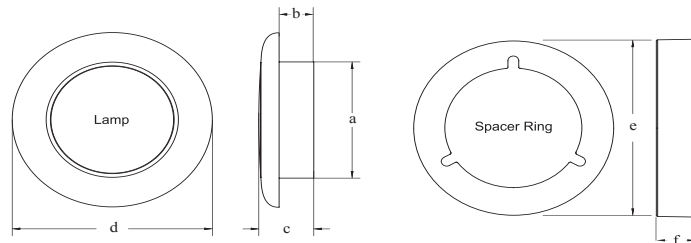

a = 50mm
b = 13mm
c = 21mm
d = 75mm plastic bezels
72mm stainless steel bezels
e = 75mm
f = 15mm

*Individual part numbers are packaged in Hella Marine blister packs.

Slim Line – Square Series



Courtesy Lamps



Variety of light and bezel colors

The attractive square LED courtesy lamps can be used for a variety of modern interior and exterior installations. Their mounting depth only accounts for 16mm. Advanced lens technology provides a cool and even spread of soft light without glare or eye strain. Enhanced brightness versions are over three times brighter than regular white and warm white LED lamps. Hella LED courtesy lamps consume a fraction of the energy of traditional bulb lamps and run very cool due to their low current draw of less than 0.5W (less than 0.04A at 12V). Hella LED technology is extremely shock, impact and vibration resistant. Each lamp is completely sealed and waterproof, UV and corrosion resistant. Bezels are available in gloss black or gloss white plastic, chrome or gold plastic or a modern satin chrome plastic. Surface mounting accessory rings provide numerous installation options with surface finishes to compliment or contrast the lamp bezels. Enhanced brightness lamps include a surface mounting spacer with a matching finish and 4x stainless steel screws (supplied only with blister packages).

- Completely sealed housing.
- UV and impact resistant plastic.
- Pre-wired with 8" (120mm) cable.
- 50mm dia. installation hole when recess mounting.
- Power Consumption: 0.5W
- Flush or Surface Mount.
- IP 67.
- (Stainless steel screws included except for bulk part numbers).



- Completely sealed housing and cable entry.
- 50mm (1.9") dia. installation hole when recess mounting.
- Pre-wired with 120mm (4.7") of marine cable.

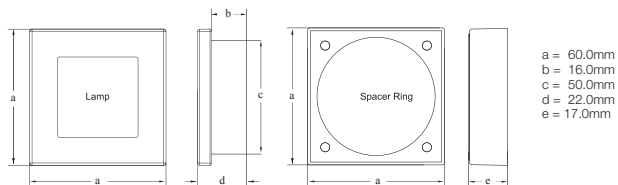

Surface Mounting Accessories

- 959993512 Chrome spacer
- 959993522 Gold spacer
- 959993532 Satin chrome spacer
- 959993602 Black spacer
- 959993542 White spacer



High intensity LED Lamps

*Each single package high intensity lamp includes a surface mounting spacer with a matching finish and 4 x stainless steel screws. Does not apply to bulk part numbers.

CLEAR LENS

White High intensity* LED Lamps

Bezel Finish	12V Part Number	24V Part Number	12V Bulk	24V Bulk
Satin chrome bezel	980580561	980581561	980580567	980581567
Chrome bezel	980580571	980581571	980580577	980581577
Gold bezel	980580531	980581531	980580537	980581537
White plastic bezel	980580551	980581551	980580557	980581557
Black plastic bezel	980580541	980581541	980580547	980581547



CLEAR LENS

Warm White High intensity* LED Lamps

Bezel Finish	12V Part Number	24V Part Number	12V Part Number	24V Part Number
Satin chrome bezel	980580761	980581761	980580767	980581767
Chrome bezel	980580771	980581771	980580777	980581777
Gold bezel	980580731	980581731	980580737	980581737
White plastic bezel	980580751	980581751	980580757	980581757
Black plastic bezel	980580741	980581741	980580747	980581747



*Individual part numbers are packaged in Hella Marine blister packs.



Slim Line – Square Series

Courtesy Lamps

Soft Light Output LED Courtesy Lamps

CLEAR LENS

White LED Courtesy Lamps

Bezel Finish	12V Part Number	24V Part Number	12V Bulk	24V Bulk
Satin chrome bezel	980580061	980581061	980580067	980581067
Chrome bezel	980580071	980581071	980580077	980581077
Gold bezel	980580031	980581031	980580037	980581037
White plastic bezel	980580051	980581051	980580057	980581057
Black plastic bezel	980580041	980581041	980580047	980581047



CLEAR LENS

Warm White LED Courtesy Lamps

Bezel Finish	12V Part Number	24V Part Number	12V Bulk	24V Bulk
Satin chrome bezel	980580261	980581261	980580267	980581267
Chrome bezel	980580271	980581271	980580277	980581277
Gold bezel	980580231	980581231	980580237	980581237
White plastic bezel	980580251	980581251	980580257	980581257
Black plastic bezel	980580241	980581241	980580247	980581247



CLEAR LENS

Amber LED Courtesy Lamps

Bezel Finish	12V Part Number	24V Part Number	12V Bulk	24V Bulk
Satin chrome bezel	980587061	980588061	980587067	980588067
Chrome bezel	980587071	980588071	980587077	980588077
Gold bezel	980587031	980588031	980587037	980588037
White plastic bezel	980587051	980588051	980587057	980588057
Black plastic bezel	980587041	980588041	980587047	980588047



CLEAR LENS

Red LED Courtesy Lamps

Bezel Finish	12V Part Number	24V Part Number	12V Bulk	24V Bulk
Satin chrome bezel	980587261	980588261	980587267	980588267
Chrome bezel	980587271	980588271	980587277	980588277
Gold bezel	980587231	980588231	980587237	980588237
White plastic bezel	980587251	980588251	980587257	980588257
Black plastic bezel	980587241	980588241	980587247	980588247



CLEAR LENS

Deep Red LED Courtesy Lamps

Bezel Finish	12V Part Number	24V Part Number	12V Bulk	24V Bulk
Satin chrome bezel	980587461	980588461	980587467	980588467
Chrome bezel	980587471	980588471	980587477	980588477
Gold bezel	980587431	980588431	980587437	980588437
White plastic bezel	980587451	980588451	980587457	980588457
Black plastic bezel	980587441	980588441	980587447	980588447



CLEAR LENS

Orange LED Courtesy Lamps

Bezel Finish	12V Part Number	24V Part Number	12V Bulk	24V Bulk
Satin chrome bezel	980587661	980588661	980587667	980588667
Chrome bezel	980587671	980588671	980587677	980588677
Gold bezel	980587631	980588631	980587637	980588637
White plastic bezel	980587651	980588651	980587657	980588657
Black plastic bezel	980587641	980588641	980587647	980588647



*Individual part numbers are packaged in Hella Marine blister packs.

Slim Line – Square Series



Courtesy Lamps

CLEAR LENS

Green LED Courtesy Lamps

Bezel Finish	12V Part Number	24V Part Number	12V Bulk	24V Bulk
Satin chrome bezel	980582061	980583061	980582067	980583067
Chrome bezel	980582071	980583071	980582077	980583077
Gold bezel	980582031	980583031	980582037	980583037
White plastic bezel	980582051	980583051	980582057	980583057
Black plastic bezel	980582041	980583041	980582047	980583047



CLEAR LENS

Blue LED Courtesy Lamps

Bezel Finish	12V Part Number	24V Part Number	12V Bulk	24V Bulk
Satin chrome bezel	980582261	980583261	980582267	980583267
Chrome bezel	980582271	980583271	980582277	980583277
Gold bezel	980582231	980583231	980582237	980583237
White plastic bezel	980582251	980583251	980582257	980583257
Black plastic bezel	980582241	980583241	980582247	980583247



CLEAR LENS

Cyan LED Courtesy Lamps

Bezel Finish	12V Part Number	24V Part Number	12V Bulk	24V Bulk
Satin chrome bezel	980582461	980583461	980582467	980583467
Chrome bezel	980582471	980583471	980582477	980583477
Gold bezel	980582431	980583431	980582437	980583437
White plastic bezel	980582451	980583451	980582457	980583457
Black plastic bezel	980582441	980583441	980582447	980583447

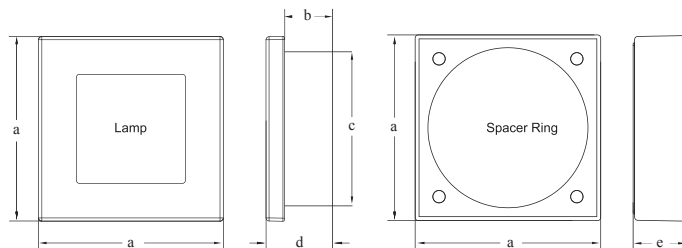

a = 60.0mm
 b = 16.0mm
 c = 50.0mm
 d = 22.0mm
 e = 17.0mm

*Individual part numbers are packaged in Hella Marine blister packs.



9510 Oblong LED Series

Courtesy Lamps

Attractive and ultra durable

These attractive and ultra durable LED courtesy lamps are ideal for illuminating steps, stairs, toe kicks storage areas, companion ways, deck fittings, signs and switches. Engineered optics ensure an even spread of light without harsh point sources. With a low current draw of less than 0.5W (less than 0.04A at 12V) Hella LED courtesy lamps are highly energy efficient. Multivolt™ versions ensure consistent illumination across a range of input voltages from 10-33 DC. Available in narrow bezel (22mm high) and wide bezel (29mm high) sizes. Attractive bezel accessories to fit wide bezel lamps only are available in polished, satin or gold 316 stainless steel finishes.

- UV and impact resistant plastic.
- Power Consumption: 0.5W.
- Pre-wired with 8" (120mm) cable.
- Flush Mount.
- IP 67.
- (Stainless steel mounting screws included except for bulk part numbers).



Accessories to suit wide rim lamps

Polished 316 Stainless Steel Bezel	998019001
Gold 316 Stainless Steel Bezel	998019011
Satin 316 Stainless Steel Bezel	959685061

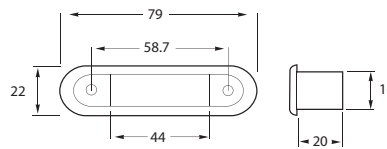
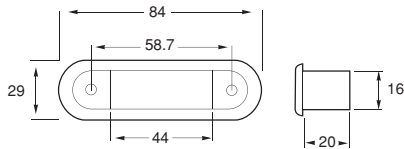

Wide Rim LED Courtesy Lamps

LED Multivolt White LED Courtesy Lamps

Voltage	Lens Color	Part Number	Bulk Part Number
10-33V	Clear	959510851	959510857

LED Multivolt Warm White LED Courtesy Lamps

Voltage	Lens Color	Part Number	Bulk Part Number
10-33V	Clear	959510901	959510907

LED Multivolt Green LED Courtesy Lamps

Voltage	Lens Color	Part Number	Bulk Part Number
10-33V	Clear	959510621	959510627

LED Multivolt Blue LED Courtesy Lamps

Voltage	Lens Color	Part Number	Bulk Part Number
10-33V	Clear	959510651	959510657

Amber LED Courtesy Lamps

Voltage	Lens Color	Part Number	Bulk Part Number
12V	Amber	959510511	959510517
24V	Amber	959510561	959510567
12V	Clear	959510501	959510507
12V DT	Clear		959510527
24V	Clear	959510551	959510557

*DT connector bulk version

Red LED Courtesy Lamps

Voltage	Lens Color	Part Number	Bulk Part Number
12V	Red	959510711	959510717
24V	Red	959510761	959510767
12V	Clear	959510701	959510707
24V	Clear	959510751	959510757

Narrow Rim LED Courtesy Lamps

LED Multivolt White LED Courtesy Lamps

Voltage	Lens Color	Part Number	Bulk Part Number
10-33V	Clear	959510451	959510457

LED Multivolt Warm White LED Courtesy Lamps

Voltage	Lens Color	Part Number	Bulk Part Number
10-33V	Clear	959510931	959510937

LED Multivolt Green LED Courtesy Lamps

Voltage	Lens Color	Part Number	Bulk Part Number
10-33V	Clear	959510151	959510157

LED Multivolt Blue LED Courtesy Lamps

Voltage	Lens Color	Part Number	Bulk Part Number
10-33V	Clear	959510251	959510257

Amber LED Courtesy Lamps

Voltage	Lens Color	Part Number	Bulk Part Number
12V	Amber	959510011	959510017
24V	Amber	959510061	959510067
12V	Clear	959510001	959510007
24V	Clear	959510051	959510057

Red LED Courtesy Lamps

Voltage	Lens Color	Part Number	Bulk Part Number
12V	Red	959510311	959510317
24V	Red	959510331	959510337
12V	Clear	959510301	959510307
24V	Clear	959510351	959510357

*Individual part numbers are packaged in Hella Marine blister packs.

Ergonomic, user-friendly design

Mini ThinLED lamps are robust low profile multi-use LED lamps ideal for general applications such as steps, ambient and storage lights. Mini ThinLED lamps feature an ergonomic and user-friendly design only 11mm high, with no sharp edges when installed. They are very well suited to wet and corrosive environments and tolerate short term immersion. Mini ThinLED lamps are completely sealed and unaffected by shock and vibration, ensuring high reliability for a true 'fit and forget' installation.

- Available with three or five LEDs
- Pre-wired with 7" (180mm) cable.
- Power Consumption: 1.7W.
- Surface Mount.
- IP 6K9K.
- (Connectors, screws and mounting hardware not included).

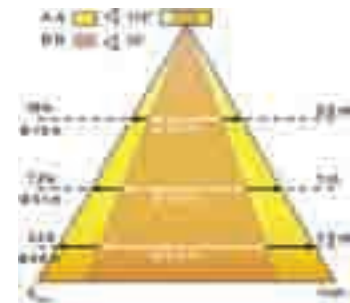

5 LED Versions

CLEAR LENS **5 White LEDs with Gray Base Plate**

Voltage	Part Number	Bulk Part Number
12V	343660101	343660107
24V	343660111	343660117



CLEAR LENS **5 Red LEDs with Gray Base Plate**

Voltage	Part Number	Bulk Part Number
12V	343660141	343660147
24V	343660151	343660157



CLEAR LENS **3 White LEDs with Gray Base Plate**

Voltage	Part Number	Bulk Part Number
12V	343660001	343660007
24V	343660011	343660017



CLEAR LENS **3 Blue LEDs with Gray Base Plate**

Voltage	Part Number	Bulk Part Number
12V	343660021	343660027
24V	343660031	343660037



CLEAR LENS **3 Red LEDs with Gray Base Plate**

Voltage	Part Number	Bulk Part Number
12V	343660041	343660047
24V	343660051	343660057



CLEAR LENS **3 Green LEDs with Gray Base Plate**

Voltage	Part Number	Bulk Part Number
12V	343660061	343660067
24V	343660071	343660077

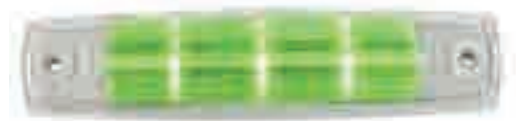



9680 LED Series

Step Lamps

Non-glare step illumination

Worldwide Hella LED step lamps are proven to be completely sealed and ultra durable. These LED step lamps feature specifically engineered optics to direct peak light downward at 30 degrees safely illuminating step tread surfaces without shining into the eyes. They are extremely energy efficient with a current draw of less than 0.5W (less than 0.04A at 12V). Multivolt™ electronics ensure consistent illumination across a range of input voltages and provide lamp protection for an ultra long service life. Bezel accessories are available in polished, satin or 316 stainless steel finishes.

- UV and impact resistant plastic.
- Red - Multivolt™ 8-28V DC; Blue, Green, White, Warm White - Multivolt™ 10-33V DC.
- IP 67
- Power Consumption: 0.5W.
- Pre-wired with 8" (120mm) of cable.
- Flush Mount.
- Completely sealed.
- (Stainless steel mounting screws included except for bulk part numbers).

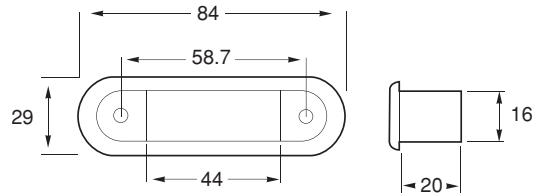

Polished 316 Stainless Steel Bezel	998019001
Gold 316 Stainless Steel Bezel	998019011
Satin 316 Stainless Steel Bezel	959685061

LED Multivolt CLEAR LENS

White LED Step Lamps

Bezel Finish	Part Number	Bulk Part Number
Polished stainless steel bezel	959680811	959680817
Gold stainless steel bezel	959680841	959680847
Satin stainless steel bezel	959680851	959680857

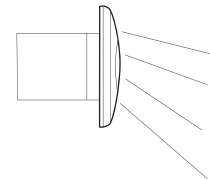

LED Multivolt CLEAR LENS

Warm White LED Step Lamps

Bezel Finish	Part Number	Bulk Part Number
Polished stainless steel bezel	959680411	959680417
Gold stainless steel bezel	959680421	959680427
Satin stainless steel bezel	959680431	959680437



Peak light output is directed down at 30 degrees.

LED Multivolt CLEAR LENS

Green LED Step Lamps

Bezel Finish	Part Number	Bulk Part Number
Polished stainless steel bezel	959680911	959680917
Gold stainless steel bezel	959680921	959680927
Satin stainless steel bezel	959680931	959680937



- Completely sealed housing and cable entry.
- Pre-wired with 120mm of cable.

LED Multivolt CLEAR LENS

Blue LED Step Lamps

Bezel Finish	Part Number	Bulk Part Number
Polished stainless steel bezel	959680611	959680617
Gold stainless steel bezel	959680621	959680627
Satin stainless steel bezel	959680631	959680637



LED Multivolt CLEAR LENS

Red LED Step Lamps

Bezel Finish	Part Number	Bulk Part Number
Polished stainless steel bezel	959680711	959680717
Gold stainless steel bezel	959680721	959680727
Satin stainless steel bezel	959680731	959680737



*Individual part numbers are packaged in Hella Marine blister packs.

Slim design

The clear lens is welded to base plate. The housing is gray. For horizontal or vertical surface-mounting, electrical connection through blade connector and grommet.

- Power Consumption: 1.4W.
- Surface Mount.
- CELIS technology.

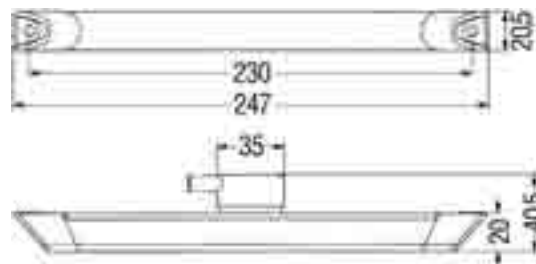

CLEAR
LENS

White LED 12V Strip Lamp – Gray Housing

Part Number
008078031

CLEAR
LENS

Blue LED 12V Strip Lamp – Gray Housing

Part Number
008078021

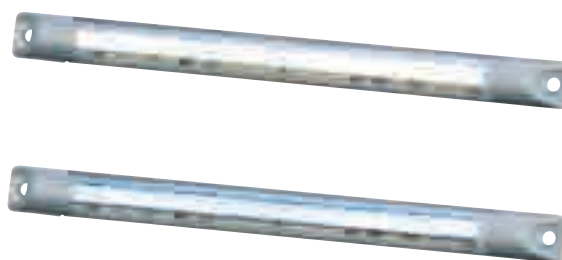



3606 LED Series

Strip Lamps

Ultra low profile

Hella 3606 Series lamps offer durable lighting in a unique surface mount design suitable for interior and exterior applications including storage lockers, under cabinets and cockpits. The entire lamp body is a shallow 10mm thick and completely sealed. 3606 Series LED lamps are highly resistant to vibration, saltwater and impact, with a current draw of less than 2W. Advanced optics are employed to provide impressive light output and energy efficiency for almost any space.

- UV resistant, enhanced impact acrylic lens.
- Available in 12V or 24V.
- Pre-wired with 10" (250mm) cable.
- Power Consumption: 1.8 W (at 12V).
- Surface Mount.
- IP 6K9K.
- (Screws and mounting hardware not included).

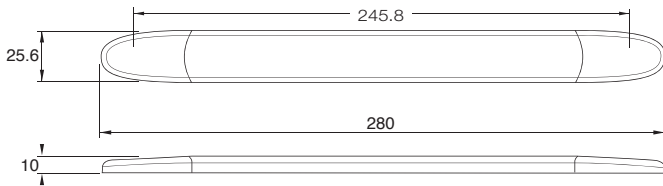
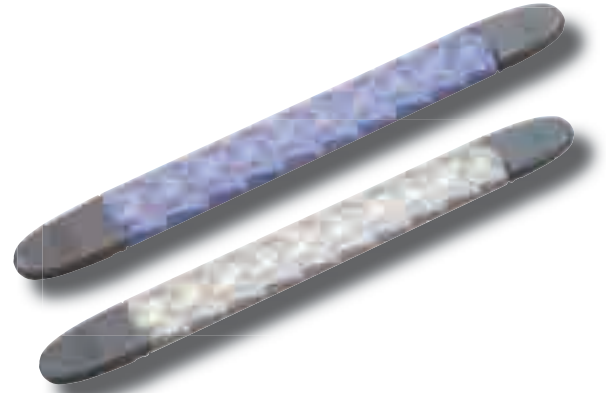

CLEAR LENS

White LED Strip Lamps

Bezel Finish	12V Part Number	24V Part Number	12V Bulk	24V Bulk
Grey caps	343606001	343606011	343606007	343606017
White caps	343606002	343606012		

CLEAR LENS

Blue LED Strip Lamps

Bezel Finish	12V Part Number	24V Part Number	12V Bulk	24V Bulk
Grey caps	343606201	343606211	343606207	343606217
White caps	343606202	343606212		

Flush mount LEDs

Hella flush mount LED strip lamps are suitable for a variety of exterior and interior applications including chart reading, lighting steps, and providing general ambient effects. The LED strip lamps provide all the power saving and reliability advantages of the Hella LED range.

- Cast in one piece.
- Available in 12V or 24V.
- IP 67 - completely sealed
- Power Consumption: 2W.
- Pre-wired with 20" (500mm) cable.
- Flush Mount.
- (Package includes screws screw caps, seal and cable clips.)

CLEAR LENS

White LED Strip Lamps

Voltage	Part Number
12V	959073001
24V	959073201



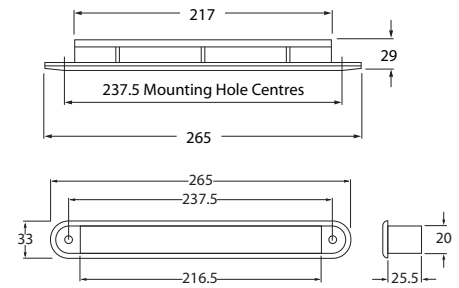

CLEAR LENS

Blue LED Strip Lamps

Voltage	Part Number
12V	959073601
24V	959073651



CLEAR LENS

Red LED Strip Lamps

Voltage	Part Number
12V	959073701
24V	959073751







Elegant LED lamps

Hella marine Waiheke series LED lamps are completely sealed energy saving devices suitable for a wide variety of lighting applications, from interior downlighting to cockpit illumination. Power consumption is very low at less than 2.0W (<0.17A@12V / <0.08A@24V) offering substantial energy saving compared to incandescent lighting. The surface temperature is very cool due to their low current draw. Three different housing designs are available which are ideal for direct or indirect illumination duties. The attractive polished 316 marine grade stainless steel bezel version offers many innovative design possibilities while the wide rim and ultra narrow lamps can be integrated into different shapes and spaces on board. All Waiheke series lamps provide comfortable color temperatures in white and warm white with excellent color rendering performance. The light color matches an equivalent Hella marine Rakino series LED downlight for consistent illumination and coordinated ambience throughout a vessel. 500mm of tinned 'twin core' cable is pre-wired and sealed into each lamp for absolute water tightness and reliable electrical connections. Waiheke series lamps represent the latest in class leading energy efficiency and maintenance free 'fit and forget' technology.

- UV resistant, enhanced impact acrylic lens.
- Available in 12V or 24V.
- Pre-wired with 20" (500mm) of twin core cable.
- Power Consumption: < 2.0W (< 0.17A @ 12V / < 0.08A @ 24V)
- IP 67 - Completely sealed.
- Stainless steel screws included.



The stainless steel bezel features a unique internal tab lock for secure attachment without visible fastenings.



Packaging for aftermarket presentation

Waiheke Candela and Lux performance. White light.

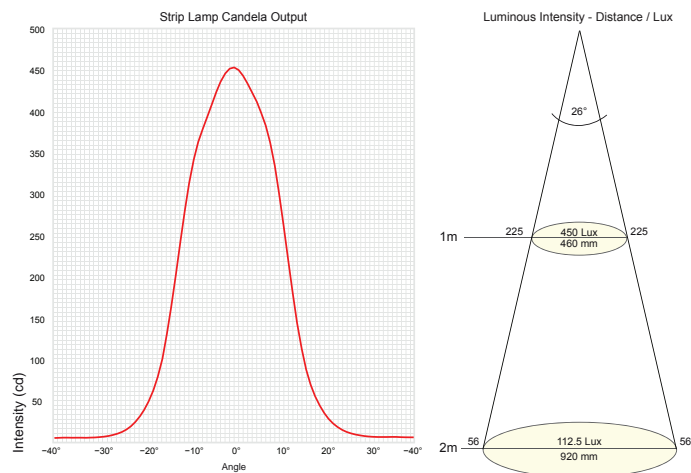

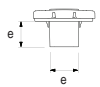
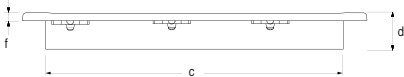
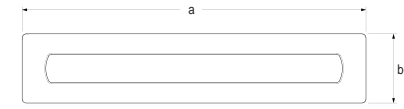

Dimensions:
 a = 250mm / 9.84f
 b = 50.0mm / 1.97f
 c = 218mm / 8.58f
 d = 28.0mm / 1.10f
 e = 20.0mm / 0.79f
 f = 6.0mm / 0.24f

White LED Strip Lamps		
Voltage	Rim Type / Finish	Part Number
12V	Wide / Stainless Bezel	980681001
24V	Wide / Stainless Bezel	980681501

Warm White LED Strip Lamps		
Voltage	Rim Type / Finish	Part Number
12V	Wide / Stainless Bezel	980681101
24V	Wide / Stainless Bezel	980681601

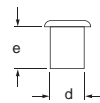
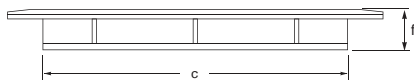
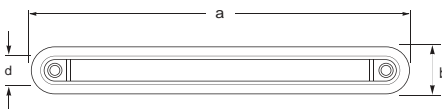

Dimensions:
 a = 265mm / 10.43f
 b = 33.0mm / 1.33f
 c = 218mm / 8.58f
 d = 20.0mm / 0.79f
 e = 25.5mm / 1.00f
 f = 29.0mm / 1.14f

White LED Strip Lamps		
Voltage	Rim Type / Finish	Part Number
12V	Wide / No Bezel	959076511
24V	Wide / No Bezel	959076611

Warm White LED Strip Lamps		
Voltage	Rim Type / Finish	Part Number
12V	Wide / No Bezel	959076561
24V	Wide / No Bezel	959076651

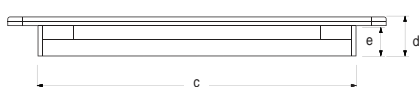
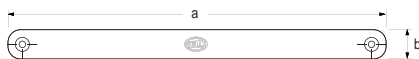

Dimensions:
 a = 257mm / 10.12f
 b = 20.0mm / 0.79f
 c = 218mm / 8.58f
 d = 26.0mm / 1.02f
 e = 20.0mm / 0.79f

White LED Strip Lamps		
Voltage	Rim Type / Finish	Part Number
12V	No rim / No Bezel	980681051
24V	No rim / No Bezel	980681551

Warm White LED Strip Lamps		
Voltage	Rim Type / Finish	Part Number
12V	No rim / No Bezel	980681151
24V	No rim / No Bezel	980681651



*Individual part numbers are packaged in Hella Marine cartons.

Interior Lighting Applications / Index

Lamp Series	Reading/ Chart Table	Steps/ Stairs	Storage	Ceiling/ Dome	Under Cabinetry	Sleeping	Driver Area/ Cockpit/ Dashboard	Exterior	Deck	Bilge
EuroLED Touch Series	X		X	X	X	X	X	X	X	X
EuroLED Series	X		X	X	X	X	X	X	X	X
DuraLED Series			X		X	X	X	X	X	
CargoLED Series			X	X	X	X		X	X	
7373 Series				X		X	X			
Rakino / Tiri Series		X	X	X	X	X				
3980 SpotLED Series – Fixed / Round		X	X	X	X	X				
3790 SpotLED Series – Swivel / Round		X	X	X	X	X				
3680 SpotLED Series – Fixed / Oval		X	X	X	X	X				
3700 / SpotLED Series – Swivel / Oval		X	X	X	X	X				
Mini OvalLED Series	X	X					X			
Flex SpotLED Series	X						X			
8560 Easy Fit LED Series		X	X					X	X	
9630 Surface Mount LED Series		X	X			X				
Slim Line Round Series		X	X		X	X		X		
Slim Line Square Series		X	X		X	X		X		
9510 Oblong LED Series		X	X			X		X		
Mini ThinLED Series		X	X							
9680 LED Series		X							X	
8078 LED CELIS Series		X								
3606 LED Series		X	X		X	X			X	
9073 LED Series		X	X		X	X			X	
Waiheke Series		X	X	X	X	X	X			

Indexed by Part Number (Numerical Order)

Part #	Series	Page	Part #	Series	Page	Part #	Series	Page
007373151	7373 Series	13	343606012	3606 LED Series	34	343660101	3660 Mini ThinLED Series	31
007373161	7373 Series	13	343606017	3606 LED Series	34	343660107	3660 Mini ThinLED Series	31
008078021	8078 LED CELIS Series	33	343606201	3606 LED Series	34	343660111	3660 Mini ThinLED Series	31
008078031	8078 LED CELIS Series	33	343606202	3606 LED Series	34	343660117	3660 Mini ThinLED Series	31
343227001	CargoLED Series	12	343606207	3606 LED Series	34	343660141	3660 Mini ThinLED Series	31
343227007	CargoLED Series	12	343606211	3606 LED Series	34	343660147	3660 Mini ThinLED Series	31
343227011	CargoLED Series	12	343606212	3606 LED Series	34	343660151	3660 Mini ThinLED Series	31
343227017	CargoLED Series	12	343606217	3606 LED Series	34	343660157	3660 Mini ThinLED Series	31
343227041	CargoLED Series	12	343660001	3660 Mini ThinLED Series	31	343680201	3680 SpotLED Series w/ CELIS - Fixed	18
343227047	CargoLED Series	12	343660007	3660 Mini ThinLED Series	31	343680207	3680 SpotLED Series w/ CELIS - Fixed	18
343570021	Mini OvalLED Series	20	343660011	3660 Mini ThinLED Series	31	343680211	3680 SpotLED Series w/ CELIS - Fixed	18
343570027	Mini OvalLED Series	20	343660017	3660 Mini ThinLED Series	31	343680217	3680 SpotLED Series w/ CELIS - Fixed	18
343570031	Mini OvalLED Series	20	343660021	3660 Mini ThinLED Series	31	343680221	3680 SpotLED Series w/ CELIS - Fixed	18
343570037	Mini OvalLED Series	20	343660027	3660 Mini ThinLED Series	31	343680227	3680 SpotLED Series w/ CELIS - Fixed	18
343570061	Mini OvalLED Series	20	343660031	3660 Mini ThinLED Series	31	343680241	3680 SpotLED Series w/ CELIS - Fixed	18
343570067	Mini OvalLED Series	20	343660037	3660 Mini ThinLED Series	31	343680247	3680 SpotLED Series w/ CELIS - Fixed	18
343570071	Mini OvalLED Series	20	343660041	3660 Mini ThinLED Series	31	343680251	3680 SpotLED Series w/ CELIS - Fixed	18
343570077	Mini OvalLED Series	20	343660047	3660 Mini ThinLED Series	31	343680257	3680 SpotLED Series w/ CELIS - Fixed	18
343570141	Mini OvalLED Series	20	343660051	3660 Mini ThinLED Series	31			
343570147	Mini OvalLED Series	20	343660057	3660 Mini ThinLED Series	31			
343606001	3606 LED Series	34	343660061	3660 Mini ThinLED Series	31			
343606002	3606 LED Series	34	343660067	3660 Mini ThinLED Series	31			
343606007	3606 LED Series	34	343660071	3660 Mini ThinLED Series	31			
343606011	3606 LED Series	34	343660077	3660 Mini ThinLED Series	31			

Index

Part #	Series	Page
959037521	DuraLED 36 Heavy-Duty Interior Lighting	9
959073001	9073 LED Series	35
959073201	9073 LED Series	35
959073601	9073 LED Series	35
959073651	9073 LED Series	35
959073701	9073 LED Series	35
959073751	9073 LED Series	35
959076511	Waiheke Series	37
959076551	Waiheke Series	37
959076561	Waiheke Series	37
959076611	Waiheke Series	37
959510001	9510 Oblong LED Series	30
959510007	9510 Oblong LED Series	30
959510011	9510 Oblong LED Series	30
959510017	9510 Oblong LED Series	30
959510051	9510 Oblong LED Series	30
959510057	9510 Oblong LED Series	30
959510061	9510 Oblong LED Series	30
959510067	9510 Oblong LED Series	30
959510151	9510 Oblong LED Series	30
959510157	9510 Oblong LED Series	30
959510251	9510 Oblong LED Series	30
959510257	9510 Oblong LED Series	30
959510301	9510 Oblong LED Series	30
959510307	9510 Oblong LED Series	30
959510311	9510 Oblong LED Series	30
959510317	9510 Oblong LED Series	30
959510331	9510 Oblong LED Series	30
959510337	9510 Oblong LED Series	30
959510351	9510 Oblong LED Series	30
959510357	9510 Oblong LED Series	30
959510457	9510 Oblong LED Series	30
959510457	9510 Oblong LED Series	30
959510507	9510 Oblong LED Series	30
959510517	9510 Oblong LED Series	30
959510527	9510 Oblong LED Series	30
959510557	9510 Oblong LED Series	30
959510567	9510 Oblong LED Series	30
959510621	9510 Oblong LED Series	30
959510627	9510 Oblong LED Series	30
959510651	9510 Oblong LED Series	30
959510657	9510 Oblong LED Series	30
959510701	9510 Oblong LED Series	30
959510707	9510 Oblong LED Series	30
959510711	9510 Oblong LED Series	30
959510717	9510 Oblong LED Series	30
959510751	9510 Oblong LED Series	30
959510757	9510 Oblong LED Series	30
959510761	9510 Oblong LED Series	30
959510767	9510 Oblong LED Series	30

Part #	Series	Page
959510851	9510 Oblong LED Series	30
959510857	9510 Oblong LED Series	30
959510901	9510 Oblong LED Series	30
959510907	9510 Oblong LED Series	30
959510931	9510 Oblong LED Series	30
959510937	9510 Oblong LED Series	30
959565017	9630 Surface Mount LED Series	23
959565037	9630 Surface Mount LED Series	23
959565067	9630 Surface Mount LED Series	23
959596001	Rakino Series	14
959596007	Rakino Series	14
959596051	Rakino Series	14
959596057	Rakino Series	14
959596101	Rakino Series	14
959596107	Rakino Series	14
959596157	Rakino Series	14
959596157	Rakino Series	14
959596501	Rakino Series	14
959596507	Rakino Series	14
959596551	Rakino Series	14
959596557	Rakino Series	14
959596601	Rakino Series	14
959596607	Rakino Series	14
959596651	Rakino Series	14
959596657	Rakino Series	14
959599001	Rakino Series	14
959599007	Rakino Series	14
959599051	Rakino Series	14
959599057	Rakino Series	14
959599101	Rakino Series	14
959599107	Rakino Series	14
959599151	Rakino Series	14
959599157	Rakino Series	14
959599501	Rakino Series	14
959599507	Rakino Series	14
959599551	Rakino Series	14
959599557	Rakino Series	14
959599601	Rakino Series	14
959599607	Rakino Series	14
959599651	Rakino Series	14
959599657	Rakino Series	14
959630151	9630 Surface Mount LED Series	23
959630157	9630 Surface Mount LED Series	23
959630251	9630 Surface Mount LED Series	23
959630257	9630 Surface Mount LED Series	23
959630351	9630 Surface Mount LED Series	23

Part #	Series	Page
959630357	9630 Surface Mount LED Series	23
959630451	9630 Surface Mount LED Series	23
959630457	9630 Surface Mount LED Series	23
959630551	9630 Surface Mount LED Series	23
959630557	9630 Surface Mount LED Series	23
959680411	9680 LED Series	32
959680417	9680 LED Series	32
959680421	9680 LED Series	32
959680427	9680 LED Series	32
959680431	9680 LED Series	32
959680437	9680 LED Series	32
959680611	9680 LED Series	32
959680617	9680 LED Series	32
959680621	9680 LED Series	32
959680627	9680 LED Series	32
959680631	9680 LED Series	32
959680637	9680 LED Series	32
959680711	9680 LED Series	32
959680717	9680 LED Series	32
959680721	9680 LED Series	32
959680727	9680 LED Series	32
959680731	9680 LED Series	32
959680737	9680 LED Series	32
959680811	9680 LED Series	32
959680817	9680 LED Series	32
959680841	9680 LED Series	32
959680847	9680 LED Series	32
959680851	9680 LED Series	32
959680857	9680 LED Series	32
959680911	9680 LED Series	32
959680917	9680 LED Series	32
959680921	9680 LED Series	32
959680927	9680 LED Series	32
959680931	9680 LED Series	32
959680937	9680 LED Series	32
959685061	9510 Oblong LED Series	30
959685061	9680 LED Series	32
959700101	DuraLED 12 LED Junior	11
959700107	DuraLED 12 LED Junior	11
959700157	DuraLED 12 LED Junior	11
959820321	EuroLED Series	7
959820327	EuroLED Series	7
959820511	EuroLED Series	7
959820517	EuroLED Series	7
959820521	EuroLED Series	7
959820527	EuroLED Series	7
959950111	EuroLED Touch Series	6

The ultimate in the art of LED lighting

Hella LED Lighting provides efficient, power saving, durable and state of the art illumination for interior and exterior applications.

Light fixtures are available for a variety of applications and purposes. From dome lamps to spot lamps and reading lamps to step lamps, Hella has the right lamp for you.





#H04206221 Hella, Inc. 6:10 Printed in USA

Hella, Inc.

201 Kelly Drive
Peachtree City, GA 30269
1.877.224.3552
www.hellausa.com
hella.faq@hella.com

